



Alcohol and Entertainment Licensing Sub-Committee

Monday 5 November 2018 at 10.00 am

Boardrooms 7&8 - Brent Civic Centre, Engineers Way,
Wembley HA9 0FJ

Membership:

Members

Councillors:

Ahmed (Chair)
Long
W Mitchell Murray

Substitute Members

Councillors:

Allie, Chohan, Hector, Kennelly, McLeish, Maurice and
RS Patel

For further information contact: Devbai Bhanji, Governance Assistant
Tel: 020 8937 4011; Email: devbai.bhanji@brent.gov.uk

For electronic copies of minutes, reports and agendas, and to be alerted when the minutes of this meeting have been published visit:

www.brent.gov.uk/committees

The press and public are welcome to attend this meeting

Notes for Members - Declarations of Interest:

If a Member is aware they have a Disclosable Pecuniary Interest* in an item of business, they must declare its existence and nature at the start of the meeting or when it becomes apparent and must leave the room without participating in discussion of the item.

If a Member is aware they have a Personal Interest** in an item of business, they must declare its existence and nature at the start of the meeting or when it becomes apparent.

If the Personal Interest is also significant enough to affect your judgement of a public interest and either it affects a financial position or relates to a regulatory matter then after disclosing the interest to the meeting the Member must leave the room without participating in discussion of the item, except that they may first make representations, answer questions or give evidence relating to the matter, provided that the public are allowed to attend the meeting for those purposes.

***Disclosable Pecuniary Interests:**

- (a) **Employment, etc.** - Any employment, office, trade, profession or vocation carried on for profit gain.
- (b) **Sponsorship** - Any payment or other financial benefit in respect of expenses in carrying out duties as a member, or of election; including from a trade union.
- (c) **Contracts** - Any current contract for goods, services or works, between the Councillors or their partner (or a body in which one has a beneficial interest) and the council.
- (d) **Land** - Any beneficial interest in land which is within the council's area.
- (e) **Licences** - Any licence to occupy land in the council's area for a month or longer.
- (f) **Corporate tenancies** - Any tenancy between the council and a body in which the Councillor or their partner have a beneficial interest.
- (g) **Securities** - Any beneficial interest in securities of a body which has a place of business or land in the council's area, if the total nominal value of the securities exceeds £25,000 or one hundredth of the total issued share capital of that body or of any one class of its issued share capital.

****Personal Interests:**

The business relates to or affects:

- (a) Anybody of which you are a member or in a position of general control or management, and:
 - To which you are appointed by the council;
 - which exercises functions of a public nature;
 - which is directed is to charitable purposes;
 - whose principal purposes include the influence of public opinion or policy (including a political party or trade union).
- (b) The interests of a person from whom you have received gifts or hospitality of at least £50 as a member in the municipal year;

or

A decision in relation to that business might reasonably be regarded as affecting the well-being or financial position of:

- You yourself;
- a member of your family or your friend or any person with whom you have a close association or any person or body who is the subject of a registrable personal interest.

Agenda

Introductions, if appropriate.

Item	Page
1	Apologies for absence and clarification of alternate members
2	Declarations of Interests
	Members are invited to declare at this stage of the meeting, the nature and existence of any relevant disclosable pecuniary or personal interests in the items on this agenda and to specify the item(s) to which they relate.
3	Application for New Premises Licence by La Bottega Di Anna Ltd for the premises known as La Bottega Di Anna, 25A Walm Lane, NW2 5SH, pursuant to the provisions of the Licensing Act 2003 1 - 28
4	Application for New Premises Licence by WM Morrisons Supermarkets Plc for the premises known as Morrisons Daily Petrol Filling Station, Honeypot Lane, NW9 6RN, pursuant to the provisions of the Licensing Act 2003 29 - 56
5	Application for Variation to a Premises Licence by Hamida Moalin for the premises known as Sahrah Lounge, 5-7 Wembley Hill Road, HA9 8AF, pursuant to the provisions of the Licensing Act 2003 57 - 96
6	Application for New Premises Licence by Satyanarayan Restaurant Ltd for the premises known as Satyanarayan Restaurant, 23-25 Queensbury Station Parade, HA8 5NR, pursuant to the provisions of the Licensing Act 2003 97 - 134



- Please remember to **SWITCH OFF** your mobile phone during the meeting.
- The meeting room is accessible by lift and seats will be provided for members of the public.

This page is intentionally left blank

LICENSING ACT 2003

Application for New Premises Licence

1. The Application

Name of Applicant:	La Bottega Di Anna Ltd
Name & Address of Premises:	La Bottega Di Anna, 25A Walm Lane NW2 5SH
Applicants Agent:	

The application is for a new premises licence:

- 1 For Sale & Supply of alcohol from 08:00hrs to 22:30hrs Monday to Sunday
Opening hours from 07:00hrs to 23:00hrs Monday to Friday and 08:00hrs to 23:00hrs Saturday & Sunday.

2. Background

None

3. Promotion of the Licensing Objectives

See page 13 of the application.

4. Relevant Representations

Representations have been received and withdrawn from Licensing Officers and the Police.
Representations remain outstanding from a local resident.

5. Interested Parties

None

6. Policy Considerations

Paragraph Nos: 7.2 8.1 – 8.4

8.1 Where responsible authorities and interested parties do not raise any relevant representations regarding the application made to the council, the council will grant the licence or certificate subject only to the conditions that are consistent with the operating schedule or club operating schedule and any mandatory conditions prescribed in the Act itself.

8.2 Where responsible authorities and interested parties raise relevant representations, the council may, if it is satisfied at a hearing or otherwise, impose conditions where considered necessary for the promotion of the licensing objectives.

8.3 Any conditions attached by the council or submitted by the applicant must focus on the direct impact of the activities taking place at licensed premises, on those attending the premises and residents and persons working in the area.

8.4 Any conditions attached to licences will be tailored to the individual needs, style and characteristics of the particular premises and events concerned and will be drawn from a 'model pool of conditions' (where appropriate) to the particular premises.

7. Determination of the Application

Members can take the following steps when determining a new premises licence application:

- grant the licence;
- exclude from the scope of the licence any of the licensable activities to which the application relates;
- refuse to specify a person in the licence as the premises supervisor;
- reject the application

8. Associated Papers

- A. Application Form & plan
- B. Public Rep
- C. Police Rep & Withdrawal
- D. Licensing Rep & Withdrawal
- E. OS Map



Brent

NEW PREMISES LICENCE APPLICATION FORM

Application for a premises licence to be granted
under the Licensing Act 2003

PLEASE READ THE FOLLOWING INSTRUCTIONS FIRST

Before completing this form please read the guidance notes at the end of the form.
If you are completing this form by hand please write legibly in **block capitals**. In all cases ensure that your answers are inside the boxes and written in **black ink**. Use additional sheets if necessary.
You may wish to keep a copy of the completed form for your records.

I/We LA BOTTEGA DI ANNA LTD

.....apply for a premises licence under
section 17 of the Licensing Act 2003 for the premises described in Part 1 below (the
premises) and I/we are making this application to you as the relevant licensing authority in
accordance with section 12 of the Licensing Act 2003

Part 1 – Premises Details

Postal address of premises or, if none, ordnance survey map reference or description	
25 A, WALM LANE	
Post town	Post code
LONDON	NW2 5SH

Telephone number of premises (if any)

Non-domestic rateable value of premises

Part 2 - Applicant details

Please state whether you are applying for a premises licence as

Please tick ✓ Yes

- a) An individual or individuals* ☐ please complete section (A)
- b) a person other than an individual* ☒ please complete section (B)
- i. as a limited company/limited liability partnership ☒ please complete section (B)
- ii. as a partnership (other than limited liability) ☐ please complete section (B)
- iii. as an unincorporated association or ☐ please complete section (B)
- iv. other (for example a statutory corporation) ☐ please complete section (B)
- c) a recognised club ☐ please complete section (B)
- d) a charity ☐ please complete section (B)
- e) the proprietor of an educational establishment ☐ please complete section (B)
- f) a health service body ☐ please complete section (B)
- g) a person who is registered under Part 2 of the Care Standards Act 2000 (c14) in respect of an independent hospital in Wales ☐ please complete section (B)
- ga) A person who is registered under Chapter 2 of Part 1 of the Health and Social Care Act 2008 (within the meaning of that Part) in an independent hospital in England ☐ please complete section (B)
- h) the chief officer of police of a police force in England and Wales ☐ please complete section (B)

* If you are applying as a person described in (a) or (b) please confirm:

Please tick ✓ Yes

- I am carrying on or proposing to carry on a business which involves the use of the premises for licensable activities; or ☒
- I am making the application pursuant to a
- o Statutory function or ☐
- o A function discharged by virtue of Her Majesty's prerogative ☐

(A) INDIVIDUAL APPLICANTS (fill in as applicable)

Mr ☐ Mrs ☐ Miss ☐ Ms ☐ Other title ☐
(for example, Rev)

Surname

First names

Date of Birth

I am 18 years old or over ☐ (Please tick yes)

Nationality

Current postal address
if different from
premises address

Post Town

Postcode

Daytime contact telephone number

E-mail address (optional)

SECOND INDIVIDUAL APPLICANT (if applicable)

Mr ☐

Mrs ☐

Miss ☐

Ms ☐

Other title
(for example, Rev) ☐

Surname

First names

Date of Birth	I am 18 years old or over <input type="checkbox"/> (Please tick yes)
Nationality	

Current postal
address
if different from
premises address

Post Town



Postcode

Daytime contact telephone number

E-mail address
(optional)

(B) OTHER APPLICANTS

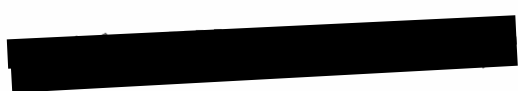
Please provide name and registered address of applicant in full. Where appropriate please give any registered number. In case of a partnership or other joint venture (other than a body corporate), please give the name and address of each party concerned.

Name	LA BOTTEGA DI ANNA LTD
Address	25 A, WALM LANE, LONDON, NW2 5SH
Registered number (where applicable)	
Description of applicant (for example, partnership, company, unincorporated association etc.)	
Telephone number (if any)	
E-mail address (optional)	

Part 3 Operating Schedule

When do you want the premises licence to start?

Day	Month	Year
1	1	0
9	2	0
1	8	

If you wish the licence to be valid only for a limited period, when do you want it to end?

--	--	--	--	--	--	--	--

If 5,000 or more people are expected to attend the premises at any one time, please state the number expected to attend

--

Please give a general description of the premises (please read guidance note 1)

GROUND FLOOR CAFE AND DELI, WITH A BASEMENT WHICH IS USED FOR STORAGE. WE ALSO HAVE A TOILET AT THE BACK OF GROUND FLOOR. A SMALL SHOP SELLING ITALIAN PRODUCTS. WE WOULD LIKE TO SELL WINE BY THE GLASS OR BOTTLE AND BEERS TO CONSUME ON THE PREMISES AND ALSO BOTTLES OF WINE OR BEERS TO TAKE OFF THE PREMISES FROM THE SMALL SHOP. WE WOULD LIKE TO BE ABLE TO SERVE ALCOHOL IN THE EXTERNAL SEATING AREAS AT THE FRONT OF THE PREMISES. ALREADY HAS THE CORRECT PERMISSION IN PLACE, IN THE FORM OF A STREET LICENCE, GRANTED BY THE LICENSING TEAM.

Please tick ✓ Yes

What licensable activities do you intend to carry on from the premises?

(Please see sections 1 and 14 of the Licensing Act 2003 and Schedule 1 and 2 to the Licensing Act 2003)

Provision of regulated entertainment

- a) plays (if ticking yes, fill in box A) ☐
- b) films (if ticking yes, fill in box B) ☐
- c) indoor sporting events (if ticking yes, fill in box C) ☐
- d) boxing or wrestling entertainment (if ticking yes, fill in box D) ☐
- e) live music (if ticking yes, fill in box E) ☐
- f) recorded music (if ticking yes, fill in box F) ☐
- g) performances of dance (if ticking yes, fill in box G) ☐
- h) anything of a similar description to that falling within (e), (f) or (g) (if ticking yes, fill in box H) ☐

Provision of late night refreshment (if ticking yes, fill in box I) ☐

Sale of alcohol (if ticking yes, fill in box J) ☒

In all cases complete boxes K, L and M

A

Plays Standard days and timings (please read guidance note 7)			Will the performance of a play take place indoors or outdoors or both – please tick [✓] (please read guidance note 3).	Indoors	
Day	Start	Finish		Outdoors	
Mon			Please give further details here (please read guidance note 4)	Both	
Tue			State any seasonal variations for performing plays (please read guidance note 5)		
Wed			Non standard timings. Where you intend to use the premises for the performance of plays at different times to those listed in the column on the left, please list (please read guidance note 6)		
Thur					
Fri					
Sat					
Sun					

I

Late night refreshment Standard days and timings (please read guidance note 7)			Will the provision of late night refreshment take place indoors or outdoors or both – please tick [✓] (please read guidance note 3).	Indoors	
Day	Start	Finish		Outdoors	
Mon			Please give further details here (please read guidance note 4)	Both	
Tue					
Wed			State any seasonal variations for the provision of late night refreshment (please read guidance note 5)		
Thur					
Fri			Non standard timings. Where you intend to use the premises for the provision of late night refreshment at different times, to those listed in the column on the left, please list (please read guidance note 6)		
Sat					
Sun					

J

Supply of alcohol Standard days and timings (please read guidance note 7)			Will the supply of alcohol be for consumption (Please tick box ✓) (please read guidance note 8)	On the premises	
Day	Start	Finish		Off the premises	
Mon	8.00 AM	10.30 PM	State any seasonal variations for the provision of late night refreshment (please read guidance note 5)	Both	✓
Tue	8.00 AM	10.30 PM			
Wed	8.00 AM	10.30 PM	Non-standard timings. Where you intend to use the premises for the supply of alcohol at different times to those listed in the column on the left, please list (please read guidance note 6)		
Thur	8.00 AM	10.30 PM			
Fri	8.00 AM	10.30 PM			
Sat	8.00 AM	10.30 PM			
Sun	8.00 AM	10.30 PM			

State the name and details of the individual whom you wish to specify on the licence as designated premises supervisor (Please see declaration about the entitlement to work in the checklist at the end of the form):

Name STEFANO PERLI

Date of Birth [REDACTED]

Address [REDACTED]

Postcode [REDACTED]

Personal Licence number (if known) [REDACTED]

Issuing licensing authority (if known) [REDACTED]

K

Please highlight any adult entertainment or services, activities, other entertainment or matters ancillary to the use of the premises that may give rise to concern in respect of children (please read guidance note 9)

NO OTHER ADULT ENTERTAINMENT APART FROM
THE SALE OF ALCOHOL

L

Hours premises are open to the public
Standard days and timings
(please read guidance note 7)

Day	Start	Finish
Mon	7.00 AM	11.00 PM
Tue	7.00 AM	11.00 PM
Wed	7.00 AM	11.00 PM
Thur	7.00 AM	11.00 PM
Fri	7.00 AM	11.00 PM
Sat	3.00 AM	11.00 PM
Sun	2.00 AM	11.00 PM

State any seasonal variation (please read guidance note 5)

Non-standard timings. Where you intend to use the premises to be open to the public at different times to those listed in the column on the left, please list (please read guidance note 6)

M Describe the steps you intend to take to promote the four licensing objectives:

a) General – all four licensing objectives (b, c, d, e) (please read guidance note 10)

STRONG MANAGEMENT CONTROL AND EFFECTIVE TRAINING OF ALL STAFF SO THAT THEY ARE AWARE OF THE PREMISES LICENCE AND THE REQUIREMENTS TO MEET THE FOUR OBJECTIVES WITH PARTICULAR ATTENTION TO:

- NO SALE OF ALCOHOL TO UNDERAGE PEOPLE
- NO DRUNK BEHAVIOUR ON THE PREMISES AREA AND NO DEALING WITH DRUGS
- VIGILANCE IN PREVENTING ANY TYPE OF HARM IN THE PREMISES
- RECORD KEEPING OF ACCIDENTS LOG BOOK

b) The prevention of crime and disorder

VIGILANCE AND AWARENESS ON ALCOHOL BOUGHT AND TOOK AWAY FROM THE PREMISES.

NO SALE TO UNDERAGE PEOPLE AND RECYCLING GLASS IN PLACE
MAIN DOOR SAFELY SHUT DOWN EVERY NIGHT.

c) Public safety

PREMISES OUTSIDE AREAS WILL BE KEPT CLEAN AND FREE OF GLASSES
IF LITTERAGE OCCURS OUTSIDE, BUT IN APPROXIMITY TO THE PREMISES,
CLEANING POLICY IN PLACE PROTECTING SUCH AREA

d) The prevention of public nuisance

NOISE IN THE PREMISES WILL NEVER BE TURNED UP ANNOYINGLY.
VIGILANCE ON CLIENTS STOPPING OUTSIDE.

e) The protection of children from harm

CHILDREN MUST BE KEPT AWAY FROM POSSIBLE DANGER POINTS IN
AND OUT THE PREMISES. IT IS RECOMMENDED PARENTS' PRESENCE
AT ALL TIMES

Checklist

Please tick ✓ Yes

- I have made or enclosed payment of the fee ☐
- I have enclosed the plan of the premises ☒
- I have sent copies of this application and the plan to responsible authorities and others where applicable ☐
- I have enclosed the consent form completed by the individual I wish to be premises supervisor, if applicable ☒
- I understand that I must now advertise my application ☒
- I understand that if I do not comply with the above requirements my application will be rejected ☒
- (Applicable to all individual applicants, including those in a partnership which is not a limited liability partnership, but not companies or limited liability partnerships) I have included documents demonstrating my entitlement to work in the United Kingdom (please read note 15). ☐

IT IS AN OFFENCE, UNDER SECTION 158 OF THE LICENSING ACT 2003, TO MAKE A FALSE STATEMENT IN OR IN CONNECTION WITH THIS APPLICATION. THOSE WHO MAKE A FALSE STATEMENT MAY BE LIABLE ON SUMMARY CONVICTION TO A FINE OF ANY AMOUNT.

IT IS AN OFFENCE UNDER SECTION 24B OF THE IMMIGRATION ACT 1971 FOR A PERSON TO WORK WHEN THEY KNOW, OR HAVE REASONABLE CAUSE TO BELIEVE, THAT THEY ARE DISQUALIFIED FROM DOING SO BY REASON OF THEIR IMMIGRATION STATUS. THOSE WHO EMPLOY AN ADULT WITHOUT LEAVE OR WHO IS SUBJECT TO CONDITIONS AS TO EMPLOYMENT WILL BE LIABLE TO A CIVIL PENALTY UNDER SECTION 15 OF THE IMMIGRATION, ASYLUM AND NATIONALITY ACT 2006 AND PURSUANT TO SECTION 21 OF THE SAME ACT, WILL BE COMMITTING AN OFFENCE WHERE THEY DO SO IN THE KNOWLEDGE, OR WITH REASONABLE CAUSE TO BELIEVE, THAT THE EMPLOYEE IS DISQUALIFIED.

Part 4 – Signatures (please read guidance note 11)

Signature of applicant or applicant's solicitor or other duly authorised agent. (Please read guidance note 12). If signing on behalf of the applicant please state in what capacity.

Declaration

- (Applicable to individual applicants only, including those in a partnership which is not a limited liability partnership) I understand I am not entitled to be issued with a licence if I do not have the entitlement to live and work in the UK (or if I am subject to a condition preventing me from doing work relating to the carrying on of a licensable activity) and that my licence will become invalid if I cease to be entitled to live and work in the UK (please read guidance note 15).
- The DPS named in this application form is entitled to work in the UK (and is not subject to conditions preventing him or her from doing work relating to a licensable activity) and I have seen a copy of his or her proof of entitlement to work, if appropriate (please see note 15)

Signature 

Date 11/09/2018

Capacity DPS AND DIRECTOR

This page is intentionally left blank

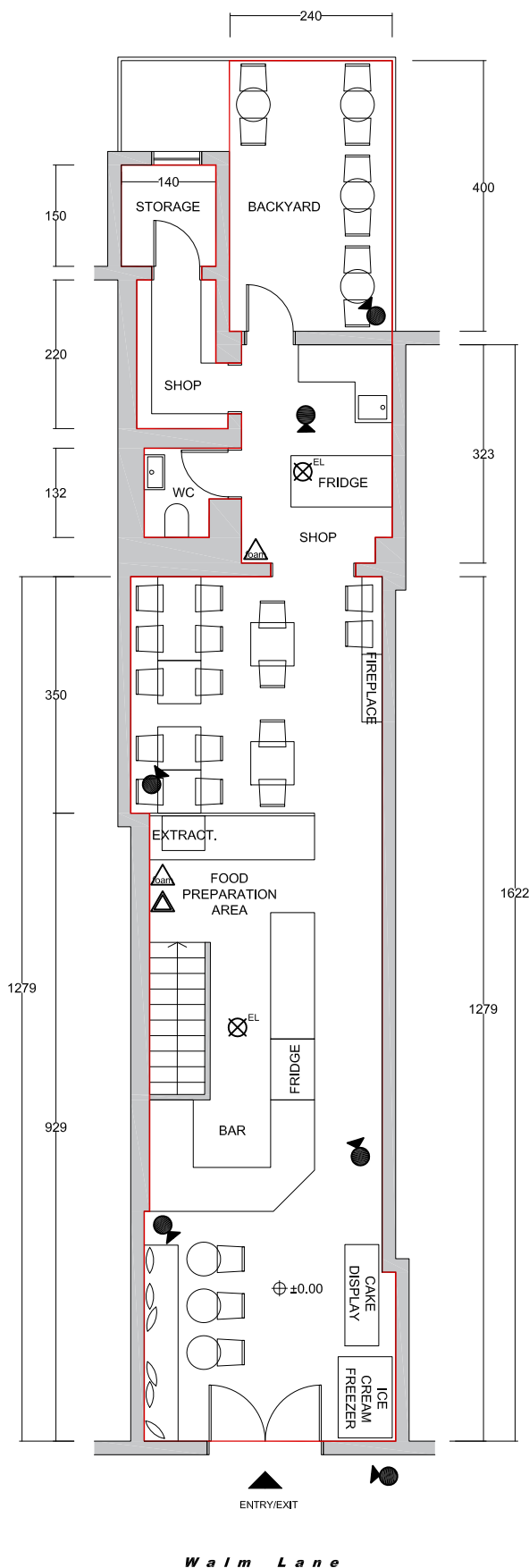

GROUND FLOOR

LEGEND	
	FIRE EXTINGUISHER 6 Litre AFFF Foam spray
	FIRE EXTINGUISHER 2Kg Carbon Dioxide Co2
	EMERGENCY LIGHTING
	CLOSED CIRCUIT TELEVISION CAMERA
	LICENSABLE ACTIVITIES

NOTE

Figured dimensions are to be used in preference to scaled dimensions.

Contractors to verify all dimensions on site before commencing any work or shop drawing.

Any discrepancies between these drawings and any other document, drawing and the actual situation encountered on site should be conveyed to the author and / or contract administrator immediately.

This drawing is to be read in conjunction with other issued project documentation and drawings.

No part of this drawing may be reproduced without the permission of the author. This drawing is property of the client. It must not be copied or distributed without their written permission.

Copyright is reserved.

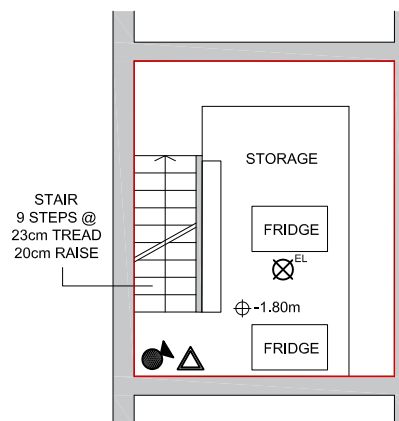

BASEMENT

DRAWING TITLE			RESTAURANT PREMISES LICENCE APPLICATION	
CLIENT	La Bottega di Anna LTD.		SCALE	DATE
AUTHOR			1:100	15.10.18
		DRAWING	REVISION	
		LA001	01	

This page is intentionally left blank

Dear Sir or Madam, recently there are a lot of bars, restaurants and late night promises are opening in Walm Lane. I put my objection I believe another alcohol promise and food selling promise is going to be a lot for Walm Lane for safety neighbourhood, pollution, and more crime during the night. This promise already is trading without A3 license and serving hot food anyway. I thing it should be stopped either. Regards

Hi, this is LA BOTTEGA DI ANNA LTD 25a walm Lane NW2 5SH. We received a public representation as attached. We understand that the area is very busy, but we would operate in selling of alcohol in the right and safest way. We are not looking for a late night licence and we will not sale cheap alcohol. We already operate whit a alcohol licence for 3 years in the previous shop (251 High Road NW10 2RX) and we never had any problem. We will and always respect neighbours, preventing noise, cleaning the premises and the front walkway, not selling alcohol to drunk people, respecting the timing.

In relation of the serving of hot food, we do but we only warm up ready made meals, we prepare fresh Panini, or we just mix some pasta(no hi risk food) whit ready made sauces, (maybe 5 per day???) so we are not running as restaurant, we are just a coffe shop and Italian food minimarket.

As a support on this, you can check our food igene rating, that is 5, so this mine that we are working hard to operate and maintain our business in perfect conditions.

Locking for earing you soon,
Kind regards.
Fenzi Stefano
Director and proposed dps of
La bottega di Anna Ltd.

P. S. It would be nice to know the name of the person who made the representation, hoping that is not some competitor.

--

Sent from Libero Mail for Android

This page is intentionally left blank

La Bottega Di Anna Ltd
25A Walm Lane
London
NW2 5SH

22nd October 2018

Our Ref: 13501

Dear Sir/Madam,

Licensing Representation to the Initial Application for the Premises Licence at La Bottega Di Anna, 25A Walm Lane, London, NW2 5SH

I certify that I have considered the application shown above and I wish to make a representation that the likely effect of the grant of the application is detrimental to the Licensing Objectives for the reasons indicated below.

An officer of the Licensing Authority, in whose area the premises are situated, who is authorised for the purposes of exercising its statutory function as a 'Responsible Authority' under the Licensing Act 2003.

The application has been made for a new premises licence under section 17 of the Act.

The Licensing Authority representations are primarily concerned with the four licensing objectives;

- the prevention of crime and disorder;
- public safety;
- the prevention of public nuisance; and
- the protection of children from harm.

The Licensing Authority require the following points to be included in the operating schedule or added as conditions on the premises licence:

1. CCTV shall be installed to Home Office Guidance standards and maintained in a good working condition and recordings shall be kept for 31 days and shall be made available to police and authorised Officers from Brent Council.
2. The CCTV system shall be capable of obtaining clear facial recognition images and a clear head and shoulders image of every person entering or leaving the premises.
3. A "Challenge 25" policy shall be adopted and adhered to at all times
4. A sign stating "No proof of age – No sale" shall be displayed at the point of sale.

5. A copy of the premises licence summary including the hours which licensable activities are permitted shall be visible from the outside of each entrance to the premises.
6. Regular documented staff training on licensing legislation and operating procedures shall be given. The training shall be signed and dated and a copy of these training records available for inspection by Police and local authority enforcement officers.
7. An incident log shall be kept at the premises, and made available for inspection on request to an authorised officer of Brent Council or the Police, which will record the following:
 - a) all crimes reported to the venue
 - (b) all ejections of patrons
 - (c) any complaints received
 - (d) any incidents of disorder
 - (e) all seizures of drugs or offensive weapons
 - (f) any faults in the CCTV system or searching equipment or scanning equipment
 - (g) any refusal of the sale of alcohol
 - (h) any visit by a relevant authority or emergency service.
8. No high strength beers, lagers, and ciders above 6.0% ABV shall be stocked or sold at the premises.
9. A clear view from eye level into the premises shall be maintained at all times.
10. Outside of the hours authorised for the sale of alcohol, all alcohol within the trading area is to be secured behind locked grills, locked screens or locked cabinet doors so as to prevent access to the alcohol by customers or staff.
11. All deliveries shall take place during the normal working day (i.e. 09:0 to 18:00 daily).
12. Notices asking customers to leave quietly shall be conspicuously displayed at all exits.
13. No noise or vibration shall be detectable at any neighbouring noise sensitive premises.
14. No 'Off' sale deliveries of alcohol will be permitted.
15. The premises shall be staffed by a minimum of 2 persons after 18:00 hours.
16. The rear outside drinking area (backyard) shall cease at 19:00 hours.
17. Customers shall not be permitted to consume alcohol in the front external area.

Plan

In conjunction with condition 18, you must amend the plan to remove licensable activities by eliminating the red line in the front external area.

In order for the Licensing Authority to withdraw this representation, it will be necessary for you to confirm that your client accept the above conditions in writing and provide an up to date plan by 22nd October 2018.

Yours faithfully



Esther Chan
Licensing Inspector
Planning, Transportation & Licensing

This page is intentionally left blank

From: Chan, Esther
Sent: 22 October 2018 14:48
To:
Cc: Business Licence <business.licence@brent.gov.uk>; Legister, Linda
<Linda.Legister@brent.gov.uk>
Subject: FW: RE: CONSULT : New Premises - 25A Walm Lane, London, NW2 5SH - 13501

Dear Stefano,

Thank you for your email and amended plan.

The Licensing Authority wish to withdraw the current representation and have no further comments.

Kind Regards
Esther Chan
Licensing Inspector

From:Stefano Fenzi
Sent: 22 October 2018 13:36
To: Chan, Esther
Subject: Re: RE: CONSULT : New Premises - 25A Walm Lane, London, NW2 5SH - 13501

Hi, confirm that I read and understood all the conditions. I accept all of them in total.
Please find attached the new floor plan.
Can you please confirm that is now everything OK?
Many thanks.

--

Sent from Libero Mail for Android

This page is intentionally left blank



**METROPOLITAN
POLICE**

Working together for a safer London

TERRITORIAL POLICING

The Licensing Authority

*Brent Civic Centre
Engineers Way
Wembley
Middlesex
HA9 0FJ*

Your ref: 13501

Our ref: 01QK/428/18/157

Brent Borough Licensing Department

*Wembley Police Station
603 Harrow Road
Wembley
HA0 2HH*

Tel: 07824868710

Email: nicola.mcdonald@met.police.uk

Web: www.met.police.uk

Date: 13/10/2018

Police representation to Premises Licence application for 'La Bottega Di Anna Ltd' 25A Walm Lane, NW2 5SH.

I certify that I have considered the application shown above and I wish to make **representations** that the likely effect of the grant of the application is detrimental to the Council's Licensing Objectives for the reasons indicated below.

Officer: **Nicola McDonald**
Licensing Constable PC 157QK

An officer of the Metropolitan Police, in whose area the premises are situated, who is authorised for the purposes of exercising its statutory function as a 'Responsible Authority' under the Licensing Act 2003.

The application has been made for a premises licence under section 17 of the act.

The Police representations are concerned with all four of the licensing objectives.

This premise is located on a busy street with high pedestrian footfall linked to the nearby railway underground station. The pavement outside is narrow and contains obstructions from roadside furniture. I understand the applicant has applied for a street trading licence to permit a small number of chairs and tables outside for his customers. Police have no concerns about this external area being used for non-alcoholic food and drinks. Police request only the rear external backyard is used for the consumption of alcohol.

Police request the following conditions be attached to annex 2 of the premises licence

CCTV shall be installed to Home Office Guidance standards and maintained in a good working condition and recordings shall be kept for 31 days and shall be made available to police and authorised Officers from Brent Council upon request.

CCTV cameras shall be installed to cover the entrance of the premises and the external areas

The CCTV system shall be capable of obtaining clear facial recognition images and a clear head and shoulders image of every person entering or leaving the premises.

Any staff directly involved in selling alcohol for retail to consumers, staff who provide training and all managers will undergo regular training of Licensing Act 2003 legislation. This will be documented and signed for by the DPS and the member of staff receiving the training. This training log shall be kept on the premises and made available for inspection by police and relevant authorities upon request.

A copy of the premises licence summary including the hours which licensable activities are permitted shall be visible from the outside of each entrance to the premises.

Notices asking customers to leave quietly shall be conspicuously displayed at all exits.

A sign stating "No proof of age – No sale" shall be displayed at the point of sale.

A "Challenge 25" policy shall be adopted and adhered to at all times.

No high strength beers, lagers, and ciders above 6.0% ABV shall be stocked or sold at the premises.

All doors and windows shall remain closed from 2100 hours daily until the premises close to the public.

An incident log shall be kept at the premises, and made available for inspection on request to an authorised officer of Brent Council or the Police, which will record the following:

- (a) all crimes reported to the venue
- (b) all ejections of patrons
- (c) any complaints received
- (d) any incidents of disorder
- (e) any faults in the CCTV system
- (f) any refusal of the sale of alcohol
- (g) any visit by a relevant authority or emergency service.

The rear outside drinking area (backyard) shall cease at 22:00 hours.

Customers shall not be permitted to consume alcohol in the front external area.

Yours Sincerely

Nicola McDonald PC 157QK
Licensing Constable Brent Police

From: Nicola.McDonald@met.pnn.police.uk [mailto:Nicola.McDonald@met.pnn.police.uk]
Sent: 16 October 2018 09:23
To:
Cc: Legister, Linda <Linda.Legister@brent.gov.uk>; Patel, Yogini <Yogini.Patel@brent.gov.uk>; Business Licence <business.licence@brent.gov.uk>
Subject: CONSULT : New Premises - 25A Walm Lane, London, NW2 5SH - 13501

Dear Stefano
Thank you for the accepting Police conditions.
Police will not be making any further representations to this application.
I look forward to meeting you soon.
Nicola

From: Stefano Fenzi
Sent: 15 October 2018 14:26
To: McDonald Nicola - QK
Subject: Re: CONSULT : New Premises - 25A Walm Lane, London, NW2 5SH - 13501

Hi, it's Fenzi Stefano, director and dps of LA BOTTEGA DI ANNA LTD 25a walm Lane NW2 5SH.
I confirm that I read and understood all conditions. I accept everything. At the moment we are waiting for the new cctv system that will be ready and operating at the end of the week. Kind regards.

--
Sent from Libero Mail for Android

This page is intentionally left blank

La Bogetta Di Anna 25A Walm Lane

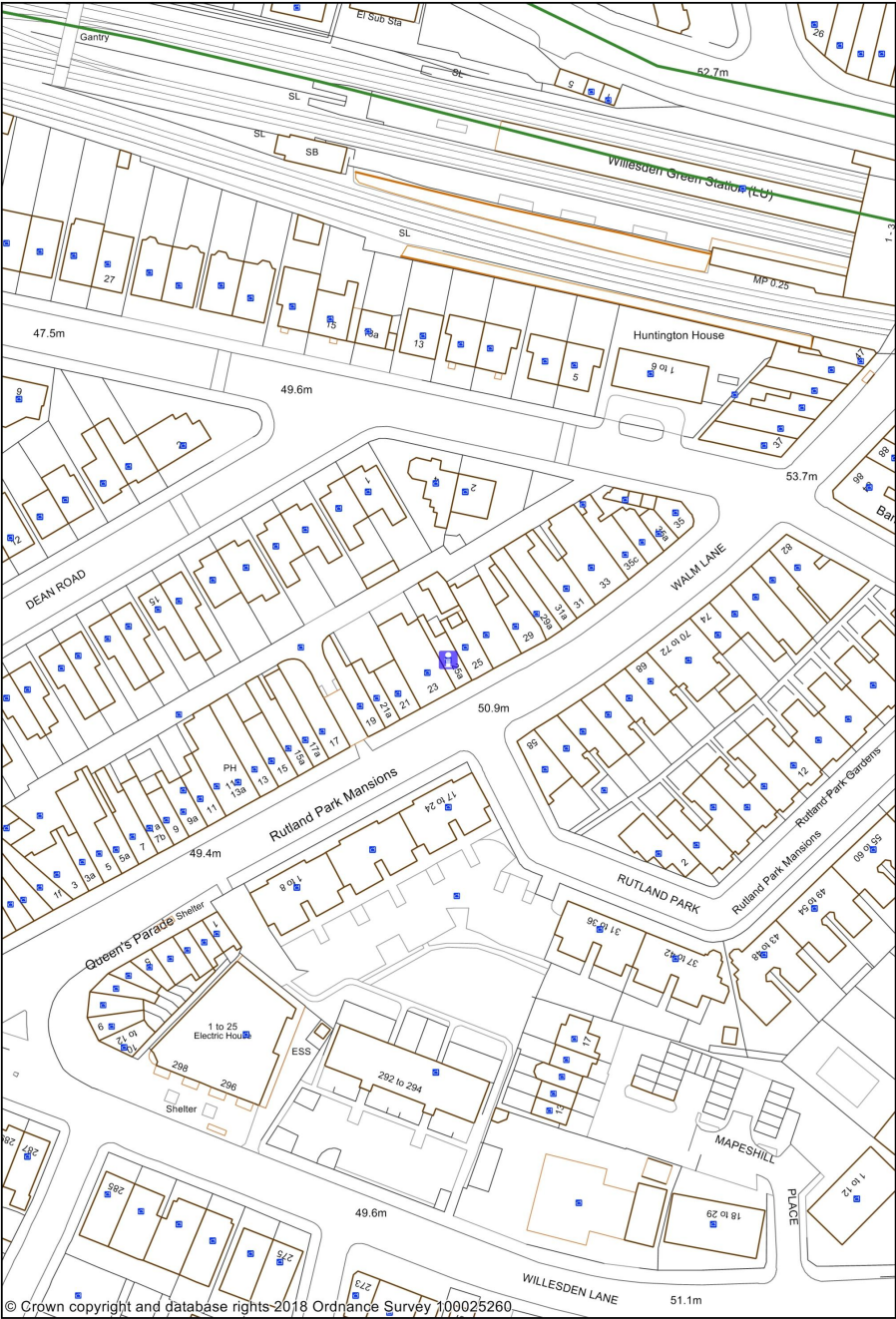

1:1250

0 0.02 0.04 kilometres



This page is intentionally left blank

LICENSING ACT 2003

Application for New Premises Licence

1. The Application

Name of Applicant:	WM Morrisons Supermarkets Plc
Name & Address of Premises:	Morrisons Daily Petrol Filling Station Honeypot Lane NW9 6RN
Applicants Agent:	Gosschalks

The application is for a new premises licence:

- 1 For Sale & Supply of alcohol from 00:00hrs to 24:00hrs Monday to Sunday
Late Night Refreshment from 23:00hrs to 05:00hrs Monday to Sunday
Opening hours from 00:00hrs to 24:00hrs Monday to Sunday.

2. Background

None

3. Promotion of the Licensing Objectives

See page 7-8 of the application.

4. Relevant Representations

Representations have been received from Licensing Officers, the Police, the Nuisance Control Team and a local residents

5. Interested Parties

None

6. Policy Considerations

Paragraph Nos: 7.2 8.1 – 8.4

8.1 Where responsible authorities and interested parties do not raise any relevant representations regarding the application made to the council, the council will grant the licence or certificate subject only to the conditions that are consistent with the operating schedule or club operating schedule and any mandatory conditions prescribed in the Act itself.

8.2 Where responsible authorities and interested parties raise relevant representations, the council may, if it is satisfied at a hearing or otherwise, impose conditions where considered necessary for the promotion of the licensing objectives.

8.3 Any conditions attached by the council or submitted by the applicant must focus on the direct impact of the activities taking place at licensed premises, on those attending the premises and residents and persons working in the area.

8.4 Any conditions attached to licences will be tailored to the individual needs, style and characteristics of the particular premises and events concerned and will be drawn from a 'model pool of conditions' (where appropriate) to the particular premises.

7. Determination of the Application

Members can take the following steps when determining a new premises licence application:

- grant the licence;
- exclude from the scope of the licence any of the licensable activities to which the application relates;
- refuse to specify a person in the licence as the premises supervisor;
- reject the application

8. Associated Papers

- A. Application Form & plan
- B. Police Rep
- C. Licensing Rep
- D. NCT Rep
- E. Public Reps
- E. OS Map

Application for a Premises Licence to be Granted under the Licensing Act 2003

PLEASE READ THE FOLLOWING INSTRUCTIONS FIRST

Before completing this form please read the guidance notes at the end of the form. If you are completing this form by hand please write legibly in block capitals. In all cases ensure that your answers are inside the boxes and written in black ink. Use additional sheets if necessary. You may wish to keep a copy of the completed form for your records.

(1) Delete as applicable.
(2) Insert name(s) of applicant.

(1) ~~[[I]]~~ (2) **[We]**

WM MORRISON SUPERMARKETS PLC

apply for a premises licence under section 17 of the Licensing Act 2003 for the premises described in Part 1 below (the premises) and (1) ~~[[I]]~~ (2) **[We are]** making this application to you as the relevant licensing authority in accordance with section 12 of the Licensing Act 2003

Part 1 - Premises Details

Postal address of premises or, if none, ordnance survey map reference or description MORRISONS DAILY PETROL FILLING STATION HONEYPOT LANE			
Post town	LONDON	Postcode	NW9 6RN
Telephone number at premises (if any)			
Non-domestic rateable value of premises		£ 1,650,000.00	

Part 2 - Applicant Details

Please state whether you are applying for a premises licence as

Please tick as appropriate

- | | | |
|--------------------------------------------------------------------------------------------------------------------------------------------------------------------------|-------------------------------------|-----------------------------|
| (a) an individual or individuals* | <input type="checkbox"/> | please complete section (A) |
| (b) a person other than an individual* | | |
| (i) as a limited company/limited liability partnership | <input checked="" type="checkbox"/> | please complete section (B) |
| (ii) as a partnership (other than limited liability) | <input type="checkbox"/> | please complete section (B) |
| (iii) as an unincorporated association or | <input type="checkbox"/> | please complete section (B) |
| (iv) other (for example a statutory corporation) | <input type="checkbox"/> | please complete section (B) |
| (c) a recognised club | <input type="checkbox"/> | please complete section (B) |
| (d) a charity | <input type="checkbox"/> | please complete section (B) |
| (e) the proprietor of an educational establishment | <input type="checkbox"/> | please complete section (B) |
| (f) a health service body | <input type="checkbox"/> | please complete section (B) |
| (g) a person who is registered under Part 2 of the Care Standards Act 2000 (c14) in respect of an independent hospital in Wales | <input type="checkbox"/> | please complete section (B) |
| (ga) a person who is registered under Chapter 2 of Part 1 of the Health and Social Care Act 2008 (within the meaning of that Part) in an independent hospital in England | <input type="checkbox"/> | please complete section (B) |

(h) the chief officer of police of a police force
in England and Wales

☐ please complete section (B)

*If you are applying as a person described in (a) or (b) please confirm (by ticking yes to one box below):

Please tick yes

- I am carrying on or proposing to carry on a business which involves the use of the premises for licensable activities; or ☒
- I am making the application pursuant to a
 - statutory function or ☐
 - a function discharged by virtue of Her Majesty's prerogative ☐

(A) INDIVIDUAL APPLICANTS (fill in as applicable)

Mr	<input type="checkbox"/>	Mrs	<input type="checkbox"/>	Miss	<input type="checkbox"/>	Ms	<input type="checkbox"/>	Other Title (for example, Rev.)	
Surname						First names			
Date of birth						I am 18 years old or over <input type="checkbox"/> Please tick yes			
Nationality									
Current residential address if different from premises address									
Post town						Postcode			
Daytime contact telephone number									
E-mail address (optional)									

SECOND INDIVIDUAL APPLICANT (if applicable)

Mr	<input type="checkbox"/>	Mrs	<input type="checkbox"/>	Miss	<input type="checkbox"/>	Ms	<input type="checkbox"/>	Other Title (for example, Rev.)	
Surname						First names			
Date of birth						I am 18 years old or over <input type="checkbox"/> Please tick yes			
Nationality									
Current residential address if different from premises address									
Post town						Postcode			
Daytime contact telephone number									
E-mail address (optional)									

(B) OTHER APPLICANTS

Please provide name and registered address of applicant in full. Where appropriate please give any registered number. In the case of a partnership or other joint venture (other than a body corporate), please give the name and address of each party concerned.

Name	WM MORRISON SUPERMARKETS PLC
Address	[REDACTED] [REDACTED] [REDACTED]
Registered number (where applicable)	[REDACTED]
Description of applicant (for example, partnership, company, unincorporated association etc.)	COMPANY
Telephone number (if any)	
E-mail address (optional)	

Part 3 - Operating Schedule

When do you want the premises licence to start?

DD		MM		YYYY			
1	8	1	0	2	0	1	8

If you wish the licence to be valid only for a limited period, when do you want it to end?

DD		MM		YYYY			

Please give a general description of the premises (please read guidance note 1)
CONVENIENCE STORE / PETROL FILLING STATION

If 5,000 or more people are expected to attend the premises at any one time, please state the number expected to attend.

--

What licensable activities do you intend to carry on from the premises?

(Please see sections 1 and 14 of the Licensing Act 2003 and Schedules 1 and 2 to the Licensing Act 2003)

Provision of regulated entertainment

Please tick all that apply

(a) plays (if ticking yes, fill in box A)

☐

(b) films (if ticking yes, fill in box B)

☐

(c) indoor sporting events (if ticking yes, fill in box C)

☐

(d) boxing or wrestling entertainment (if ticking yes, fill in box D)

☐

(e) live music (if ticking yes, fill in box E)

☐

(f) recorded music (if ticking yes, fill in box F)

☐

(g) performances of dance (if ticking yes, fill in box G)

☐

(h) anything of a similar description to that falling within (e), (f) or (g)
(if ticking yes, fill in box H)

☐

Provision of late night refreshment (if ticking yes, fill in box I)

☒

Supply of alcohol (if ticking yes, fill in box J)

☒

In all cases complete boxes K, L and M

Late night refreshment Standard days and timings (please read guidance note 7)			Will the provision of late night refreshment take place indoors or outdoors or both - please tick (please read guidance note 3)	Indoors	<input type="checkbox"/>
				Outdoors	<input type="checkbox"/>
				Both	<input checked="" type="checkbox"/>
Day	Start	Finish	Please give further details here (please read guidance note 4)		
Mon	2300	0500			
Tue	2300	0500			
Wed	2300	0500	State any seasonal variations for the provision of late night refreshment (please read guidance note 5)		
Thur	2300	0500			
Fri	2300	0500			
Sat	2300	0500	Non standard timings. Where you intend to use the premises for the provision of late night refreshment at different times to those listed in the column on the left, please list (please read guidance note 6)		
Sun	2300	0500			

J

Supply of alcohol Standard days and timings (please read guidance note 7)			Will the supply of alcohol be for consumption - please tick (please read guidance note 8)	On the premises	<input type="checkbox"/>
				Off the premises	<input checked="" type="checkbox"/>
				Both	<input type="checkbox"/>
Day	Start	Finish	State any seasonal variations for the supply of alcohol (please read guidance note 5)		
Mon	0000	2400			
Tue	0000	2400			
Wed	0000	2400	Non standard timings. Where you intend to use the premises for the supply of alcohol at different times to those listed in the column on the left, please list (please read guidance note 6)		
Thur	0000	2400			
Fri	0000	2400			
Sat	0000	2400			
Sun	0000	2400			

State the name and details of the individual whom you wish to specify on the licence as designated premises supervisor (Please see declaration about the entitlement to work in the checklist at the end of the form):

Name	KELLY LOUISE NICHOLS
Date of birth	
Address	
Postcode	
Personal licence number (if known)	
Issuing licensing authority (if known)	

K

Please highlight any adult entertainment or services, activities, other entertainment or matters ancillary to the use of the premises that may give rise to concern in respect of children (please read guidance note 9)

NONE.

L

Hours premises are open to the public Standard days and timings (please read guidance note 7)			State any seasonal variations (please read guidance note 5)
Day	Start	Finish	Non standard timings. Where you intend the premises to be open to the public at different times to those listed in the column on the left, please list (please read guidance note 6)
Mon	0000	2400	
Tue	0000	2400	
Wed	0000	2400	
Thur	0000	2400	
Fri	0000	2400	
Sat	0000	2400	
Sun	0000	2400	

M

Describe the steps you intend to take to promote the four licensing objectives:

(a) General - all four licensing objectives (b, c, d and e) (please read guidance note 10)

ALL STAFF ENGAGED IN THE SALE OF ALCOHOL WILL BE TRAINED IN ACCORDANCE WITH THE PREMISES LICENCE HOLDER'S TRAINING PROCEDURES.

(b) The prevention of crime and disorder

ALL STAFF ENGAGED IN THE SALE OF ALCOHOL WILL RECEIVE SUITABLE TRAINING (INCLUDING REFRESHER TRAINING) IN RELATION TO THE PROOF OF AGE "CHALLENGE 25" SCHEME TO BE APPLIED ON THE PREMISES. THE FOLLOWING FORMS OF IDENTIFICATION ARE ACCEPTABLE: PHOTO DRIVING LICENCE, PASSPORT, PROOF OF AGE STANDARDS SCHEME (PASS) CARD, MILITARY ID AND ANY OTHER LOCALLY OR NATIONALLY APPROVED FORM OF IDENTIFICATION.

CCTV SHALL BE PROVIDED ON THE PREMISES AND SHALL BE KEPT IN GOOD WORKING ORDER.

ALL CHECKOUT OPERATORS WILL OPERATE A REFUSAL LOG.

(c) Public safety

THE PREMISES LICENCE HOLDER UNDERTAKES ONGOING RISK ASSESSMENTS IN ORDER TO COMPLY WITH HEALTH & SAFETY LEGISLATION.

(d) The prevention of public nuisance

THE PREMISES ARE RESPONSIBLY MANAGED AND SUPERVISED. NO ADDITIONAL MEASURES ARE BELIEVED NECESSARY.

(e) The protection of children from harm

ALL STAFF ENGAGED IN THE SALE OF ALCOHOL WILL RECEIVE SUITABLE TRAINING (INCLUDING REFRESHER TRAINING) IN RELATION TO THE PROOF OF AGE "CHALLENGE 25" SCHEME TO BE APPLIED ON THE PREMISES. THE FOLLOWING FORMS OF IDENTIFICATION ARE ACCEPTABLE: PHOTO DRIVING LICENCE, PASSPORT, PROOF OF AGE STANDARDS SCHEME (PASS) CARD, MILITARY ID AND ANY OTHER LOCALLY OR NATIONALLY APPROVED FORM OF IDENTIFICATION.

TILL PROMPTS ARE IN USE AT THE STORE.

Checklist:

Please tick to indicate agreement

- | | |
|--------------------------------------------------------------------------------------------------------------------------------------------------------------------------------------------------------------------------------------|-------------------------------------|
| • I have made or enclosed payment of the fee. | <input checked="" type="checkbox"/> |
| • I have enclosed the plan of the premises. | <input checked="" type="checkbox"/> |
| • I have sent copies of this application and the plan to responsible authorities and others where applicable. | <input checked="" type="checkbox"/> |
| • I have enclosed the consent form completed by the individual I wish to be designated premises supervisor, if applicable. | <input checked="" type="checkbox"/> |
| • I understand that I must now advertise my application. | <input checked="" type="checkbox"/> |
| • I understand that if I do not comply with the above requirements my application will be rejected. | <input checked="" type="checkbox"/> |
| • [Applicable to all individual applicants, including those in a partnership which is not limited liability partnership] I have included documents demonstrating my entitlement to work in the United Kingdom (please read note 15). | <input checked="" type="checkbox"/> |

IT IS AN OFFENCE, UNDER SECTION 158 OF THE LICENSING ACT 2003, TO MAKE A FALSE STATEMENT IN OR IN CONNECTION WITH THIS APPLICATION. THOSE WHO MAKE A FALSE STATEMENT MAY BE LIABLE ON SUMMARY CONVICTION TO A FINE OF ANY AMOUNT.

IT IS AN OFFENCE UNDER SECTION 24B OF THE IMMIGRATION ACT 1971 FOR A PERSON TO WORK WHEN THEY KNOW, OR HAVE REASONABLE CAUSE TO BELIEVE, THAT THEY ARE DISQUALIFIED FROM DOING SO BY REASON OF THEIR IMMIGRATION STATUS. THOSE WHO EMPLOY AN ADULT WITHOUT LEAVE OR WHO IS SUBJECT TO CONDITIONS AS TO EMPLOYMENT WILL BE LIABLE TO A CIVIL PENALTY UNDER SECTION 15 OF THE IMMIGRATION, ASYLUM AND NATIONALITY ACT 2006 AND PURSUANT TO SECTION 21 OF THE SAME ACT, WILL BE COMMITTING AN OFFENCE WHERE THEY DO SO IN THE KNOWLEDGE, OR WITH REASONABLE CAUSE TO BELIEVE, THAT THE EMPLOYEE IS DISQUALIFIED.

Part 4 - Signatures (please read guidance note 11)

Signature of applicant or applicant's solicitor or other duly authorised agent (see guidance note 12).
If signing on behalf of the applicant, please state in what capacity.

Declaration	<ul style="list-style-type: none">[Applicable to individual applicants only, including those in a partnership which is not a limited liability partnership] I understand I am not entitled to be issued with a licence if I do not have the entitlement to live and work in the UK (or if I am subject to a condition preventing me from doing work relating to the carrying on of a licensable activity) and that my licence will become invalid if I cease to be entitled to live and work in the UK (please read guidance note 15).The DPS named in this application form is entitled to work in the UK (and is not subject to conditions preventing him or her from doing work relating to a licensable activity) and I have seen a copy of his or her proof of entitlement to work, if appropriate (please see note 15)		
Signature	<i>Gosschalks</i>		
Date	18 SEPTEMBER 2018		
Capacity	SOLICITORS ON BEHALF OF THE APPLICANT		
For joint applications, signature of 2nd applicant or 2nd applicant's solicitor or other authorised agent (please read guidance note 12). If signing on behalf of the applicant, please state in what capacity.			
Signature			
Date			
Capacity			
Contact name (where not previously given) and postal address for correspondence associated with this application (please read guidance note 14) Gosschalks Solicitors [REDACTED] [REDACTED] [REDACTED]			
Post town	[REDACTED]	Postcode	[REDACTED]
Telephone number (if any)	[REDACTED]		
If you would prefer us to correspond with you by e-mail, your e-mail address (optional) [REDACTED]			

Notes for Guidance

1. Describe the premises, for example the type of premises, its general situation and layout and any other information which could be relevant to the licensing objectives. Where your application includes off-supplies of alcohol and you intend to provide a place for consumption of these off-supplies, you must include a description of where the place will be and its proximity to the premises.
2. In terms of specific regulated entertainments please note that:
 - **Plays:** no licence is required for performances between 08:00 and 23:00 on any day, provided that the audience does not exceed 500.
 - **Films:** no licence is required for 'not-for-profit' film exhibition held in community premises between 08:00 and 23:00 on any day provided that the audience does not exceed 500 and the organiser (a) gets consent to the screening from a person who is responsible for the premises; and (b) ensures that each such screening abides by age classification ratings.
 - **Indoor sporting events:** no licence is required for performances between 08:00 and 23:00 on any day, provided that the audience does not exceed 1000.
 - **Boxing or Wrestling Entertainment:** no licence is required for a contest, exhibition or display of Greco-Roman wrestling, or freestyle wrestling between 08:00 and 23:00 on any day, provided that the audience does not exceed 1000. Combined fighting sports- defined as a contest, exhibition or display which combines boxing or wrestling with one or more martial arts- are licensable as a boxing or wrestling entertainment rather than an indoor sporting event.
 - **Live music:** no licence permission is required for:
 - a performance of unamplified live music between 08:00 and 23:00 on any day, on any premises.
 - a performance of amplified live music between 08:00 and 23:00 on any day on premises authorised to sell alcohol for consumption on those premises, provided that the audience does not exceed 500.
 - a performance of amplified live music between 08:00 and 23:00 on any day, in a workplace that is not licensed to sell alcohol on those premises, provided that the audience does not exceed 500.
 - a performance of amplified live music between 08:00 and 23:00 on any day, in a church hall, village hall, community hall, or other similar community premises, that is not licensed by a premises licence to sell alcohol, provided that (a) the audience does not exceed 500, and (b) the organiser gets consent for the performance from a person who is responsible for the premises.
 - a performance of amplified live music between 08:00 and 23:00 on any day, at the non-residential premises of (i) a local authority, or (ii) a school, or (iii) a hospital, provided that (a) the audience does not exceed 500, and (b) the organiser gets consent for the performance on the relevant premises from: (i) the local authority concerned, or (ii) the school or (iii) the health care provider for the hospital.
 - **Recorded Music:** no licence permission is required for;
 - any playing of recorded music between 08:00 and 23:00 on any day on premises authorised to sell alcohol for consumption on those premises, provided that the audience does not exceed 500.
 - any playing of recorded music between 08:00 and 23:00 on any day, in a church hall, village hall, community hall, or other similar community premises, that is not licensed by a premises licence to sell alcohol, provided that (a) the audience does not exceed 500, and (b) the organiser gets consent for the performance from a person who is responsible for the premises.
 - any playing of recorded music between 08:00 and 23:00 on any day, at the non-residential premises of (i) a local authority, or (ii) a school, or (iii) a hospital, provided that (a) the audience does not exceed 500, and (b) the organiser gets consent for the performance on the relevant premises from: (i) the local authority concerned, or (ii) the school proprietor or (iii) the health care provider for the hospital.
 - **Dance:** no licence is required for performances between 08:00 and 23:00 on any day, provided that the audience does not exceed 500. However, a performance which amounts to adult entertainment remains licensable.
 - **Cross activity exemptions:** no licence is required between 08:00 and 23:00 on any day, with no limit on audience size for:
 - any entertainment taking place on the premises of the local authority where the entertainment is provided by or on behalf of the local authority;
 - any entertainment taking place on the hospital premises of the health care provider where the entertainment is provided by or on behalf of the health care provider;
 - any entertainment taking place on the premises of the school where the entertainment is provided by or on behalf of the school proprietor; and
 - any entertainment (excluding films and a boxing or wrestling entertainment) taking place at a travelling circus, provided that (a) it takes place within a moveable structure that accommodates the audience, and (b) that the travelling circus has not been located on the same site for more than 28 consecutive days.
3. Where taking place in a building or other structure please tick as appropriate (indoors may include a tent.)

Relocated 2No.
Parking Spaces

New Landscaped Area

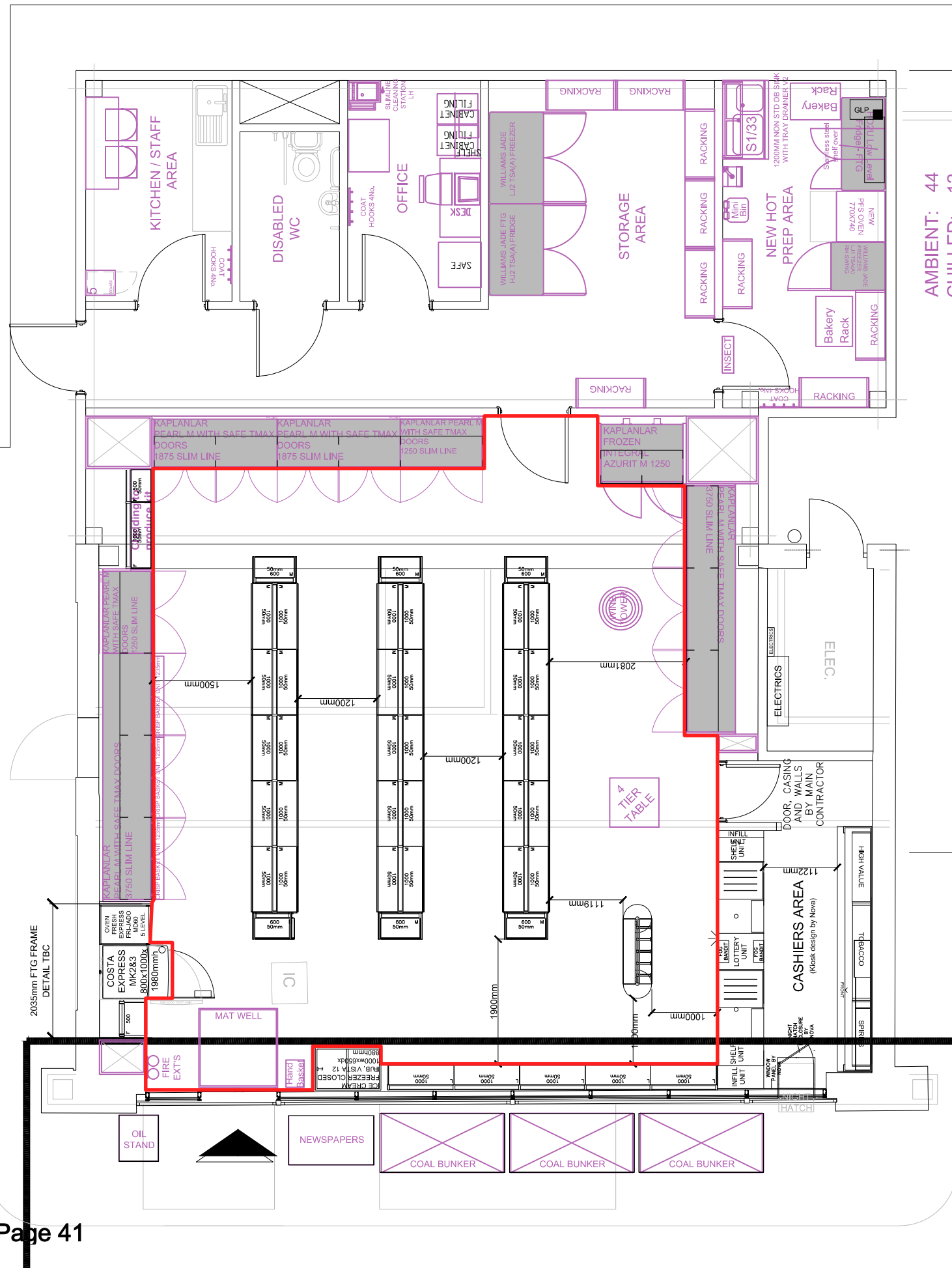

AMBIENT: 44
CHILLED: 12

Landscaping
extended

Parking Space

Parking Space

Parking Space

1307/Queensbury

1307/B/SK1/BWSL/001

RETAIL SALES AREA 1223 sq. ft

Scale: 1:75

only scaled on
A3



Wm MORRISON SUPERMARKETS PLC
Property & Development Division

Hillmore House, Gains Lane, Bradford BD3 7JL
Tel: 0845 611 5000 Fax: 0845 611 6738 email: info@wmproperty.co.uk

This page is intentionally left blank



**METROPOLITAN
POLICE**

Working together for a safer London

TERRITORIAL POLICING

Brent Police Licensing Unit

*Brent Civic Centre
Engineers Way
Wembley
Middlesex
HA9 0FJ*

Brent Borough Licensing Department

*Wembley Police Station
603 Harrow Road
Wembley
HA0 2HH*

Tel: 020 8733 3206

Email: Darren.cowley@met.police.uk

Web: www.met.police.uk

Your ref: L.A.Ref 13536

Date: 13th October 2018

Our ref: 01QK/440/18/548

Police representation to the Premises Licence application for 'Morrisons Daily Petrol Station, Honeypot Lane, NW9 6RN.

I certify that I have considered the application shown above and **I wish to make representations** that the likely effect of the grant of the application is detrimental to the Council's Licensing Objectives for the reasons indicated below.

I am of the opinion that the risk to the Council's objectives can be mitigated by removing the requested variations or attaching conditions to the Licence as shown below.

If these conditions were accepted in full **I would** withdraw my representation.

Officer: **Darren Cowley**
Licensing Constable PC548QK

An officer of the Metropolitan Police, in whose area the premises are situated, who is authorised for the purposes of exercising its statutory function as a 'Responsible Authority' under the Licensing Act 2003.

The application has been made for a premises licence under section 17 of the act.

The Police representations are primarily concerned with crime and disorder.

Police require the following points should be included in the operating schedule or added as conditions on the premises licence.

A "Challenge 25" policy shall be adopted and adhered to at all times.

CCTV shall be installed to Home Office Guidance standards and maintained in a good working condition and recordings shall be kept for 31 days and shall be made available to police and authorised Officers from Brent Council

A CCTV camera shall be installed to cover the entrance of the premises and further cameras installed to cover the counter and till.

An incident log shall be kept at the premises, and made available for inspection on request to an authorised officer of Brent Council or the Police, which will record the following:

- (a) all crimes reported to the venue
- (b) all refusals
- (c) any complaints received
- (d) any incidents of disorder
- (e) any faults in the CCTV system
- (f) any refusal of the sale of alcohol
- (g) any visit by a relevant authority or emergency service.

Any staff directly involved in selling alcohol for retail to consumers and staff who provide training including managers shall undergo regular training of the Licensing Act 2003 legislation (at least every 12 months). The training shall be documented and signed off by the DPS and the member of staff receiving the training. This training log shall be kept on the premises and made available for inspection by police and relevant authorities upon request.

A sign stating 'No proof of age, No sale' shall be displayed at the point of sale.

No high strength beers, lagers, and ciders above 6.0% ABV shall be stocked.
No single cans of beers, lagers and ciders shall be sold at the premises.

A copy of the premises licence summary including the hours which licensable activities are permitted shall be visible from the outside of each entrance to the premises.

Yours Sincerely

Darren Cowley 548QK
Licensing Constable Brent Police

Morrisons Daily Petrol Filling Station
Honeypot Lane
London
NW9 6RN

12 October 2018

Licensing Representation for the New Premises Licence Application, Morrisons Daily Petrol Filling Station, Honeypot Lane, London, NW9 6RN

I certify that I have considered the application shown above and I wish to make a representation that the likely effect of the grant of the application is detrimental to the Licensing Objectives for the reasons indicated below.

Officer: Susana Figueiredo – Licensing Inspector

An officer of the Licensing Authority, in whose area the premises are situated, who is authorised for the purposes of exercising its statutory function as a 'Responsible Authority' under the Licensing Act 2003.

The application has been made for a new premises licence under section 17 of the Act.

Change of Opening Hours

The Licensing Authority is of the opinion that the proposed hours for the supply of alcohol would undermine the Licensing objectives. There are a number of issues relating to the local area in terms of street drinking which has worsened. By providing a premises which supplies alcohol 24 hours a day, it is believed that this will encourage both the purchasing of alcohol as a result of the length of proposed timings and street drinking.

It is fair to say that premises in the local area have stringent conditions in place but this has not deterred from the problem. The reason being, is that street drinkers traditionally appeared in a way that was obvious to everyone. This is not the case anymore and the fact is, it can be difficult for staff selling alcohol to distinguish who does and does not have an alcohol related problem. It also then presents the problem that staff may not be aware that those persons with said drinking problems will then sit and drink in the street.

Despite looking at this case individually, on its own merit, it is difficult to avoid the bigger issue of alcohol in the area.

The Licensing Authority is not limiting suggestions from the applicant as to how this may be combatted but as it stands, there are too many concerns about the existing street drinking in the area to ignore the problem, just because the premises is a petrol station and not a traditional off licence.

For the above reasons the Licensing Authority request that the permitted hours for sale of alcohol be reduced from:

Monday to Sunday 00:00 – 24:00

To

Monday to Sunday 10.00hrs – 23.00hrs

in order to ensure the Licensing objectives are upheld.

Late Night Refreshment

The Licensing Authority have no objection to the proposed timings for late night refreshment.

Conditions to be added to the Premises Licence

Based on the above reduced timings, the Licensing Authority suggest the following conditions to ensure that all four Licensing objectives are met.

- A “Challenge 25” policy shall be adopted and adhered to at all times.
- CCTV shall be installed to Home Office Guidance standards and maintained in a good working condition and recordings shall be kept for 31 days and shall be made available to police and authorised Officers from Brent Council
- A CCTV camera shall be installed to cover the entrance of the premises and further cameras installed to cover the entire serving counter and till.
- An incident log shall be kept at the premises, and made available for inspection on request to an authorised officer of Brent Council or the Police, which will record the following:
 - (a) all crimes reported to the venue
 - (b) all refusals
 - (c) any complaints received
 - (d) any incidents of disorder
 - (e) any faults in the CCTV system
 - (f) any refusal of the sale of alcohol
 - (g) any visit by a relevant authority or emergency service.
- Any staff directly involved in selling alcohol for retail to consumers and staff who provide training including managers shall undergo regular training of the Licensing Act 2003 legislation (at least every 12 months). The training shall be documented and signed off by the DPS and the member of staff receiving the training. This training log shall be kept on the premises and made available for inspection by police and relevant authorities upon request.
- Outside of the hours authorised for the sale of alcohol, all alcohol within the trading area is to be secured behind locked grills, locked screens or locked cabinet doors so as to prevent access to the alcohol by customers or staff.
- A sign stating ‘No proof of age, No sale’ shall be displayed at the point of sale.
- No high strength beers, lagers, and ciders above 6.0% ABV shall be stocked.

- No single cans of beers, lagers and ciders shall be stocked or sold at the premises.
- A copy of the premises licence summary including the hours which licensable activities are permitted shall be visible from the outside of each entrance to the premises.

In order for the Licensing Team to withdraw this representation, it will be necessary for you to confirm the above.

Yours faithfully,



Susana Figueiredo
Licensing Inspector
Planning, Transportation & Licensing

This page is intentionally left blank

Regulatory Services MEMORANDUM

LICENSING CONSULTATION -INTERNAL MEMO

To: Wm Morrison Supermarkets Plc
From: Jason Nelson
Cc:
Date: 06/10/2018
Premises: Petrol Station, Morrisons, Honeypot Lane, London, NW9 6RN
Type of Application: New
Reference: 13536
Licensable activities: Late night refreshments, Supply of alcohol.
Start Date: 18/10/2018

Dear Wm Morrison Supermarkets Plc,

I would like to confirm that I have considered the above proposal with regard to the prevention of public nuisance.

On behalf of Regulatory Services (Environmental Health) I would like to make representations to the Application.

On the following grounds:

That the proposed operating hours to supply alcohol are inappropriate due to public nuisance in the area, and the close proximity of residential dwellings.

Informative

I would recommend the following alterations/conditions to the operating schedule:

Nuisance Control has no objection to the late night refreshments that has been proposed, but would suggest the applicant revise the proposed time from 00:00 - 24:00, to 06:00 - 00:00 for supplying alcohol.

The super store has the same hours attached to the licence, and gives the local residents 6 hours from midnight some quality enjoyment of their property without public nuisance caused by people congregating, loitering at unsociable hours.

Condition

The following condition should be attached if the application is to be granted.

Supply of alcohol from 6am until midnight, 7 days a week.

Kind Regards

Jason Nelson
Enforcement Officer
Nuisance Control Team

This page is intentionally left blank

Alcohol Licensing,
Regulatory Services,
Brent Council,
Brent Civic Centre,
Engineers' Way,
Wembley,
HA9 0FJ



10th October 2018

Dear Sir,

Application for Premises Licence – Morrison's Daily Petrol Filling Station

I am writing to you in connection with the application by Morrison's Supermarkets for a Premises Licence under Section 17 of the Licensing Act 2003.

I understand that Morrison's wish to apply for a licence either to sell alcohol from Mondays to Sundays between the hours of 00.00 and 24.00 – i.e. with no restriction on the hours of sale whatsoever, and/or for a permit for late night refreshment from Mondays to Sundays between the hours of 23.00 and 05.00 at the petrol station.

I sincerely hope that both of these applications will be rejected. It is already possible to buy alcohol in Morrison's supermarket during their opening hours – from 07.00 until 23.00 on Mondays to Saturdays and from 10.00 until 16.00 on Sundays. There is therefore ample time and opportunity for anyone wishing to purchase alcohol to be able to do so. Furthermore, there are also several shops around Queensbury station where it is also possible to purchase alcohol during the normal opening hours.

The proposals by Morrison's to effectively allow the unrestricted sale of alcohol are contrary to the intentions of the Licensing laws. The limit on hours in which alcohol can be purchased has been put in place to protect individuals and the public in general both for health and safety reasons and for public order. Should Morrison's applications be granted these protections will be removed. The type of person wishing or needing to purchase alcohol outside of the normal shopping hours is likely to either have an alcohol dependency problem or be inclined towards public disorder. Further, if alcohol is sold at a petrol filling station there is a risk that the purchaser will be liable to break the drink-driving laws, potentially causing harm to innocent members of the public.

On Monday of this week, 8th October, there was a public meeting for residents of Queensbury, Kenton East and Edgware wards in Harrow, attended by the local police, amongst others, at which a number of residents living near Queensbury station expressed concerns about the behaviour of groups of young men gathering near the station, drinking or

under the influence of drink. If Morrison's application is granted this type of unruly behaviour is likely to increase, with resulting disruption to the local residents and to the many more residents who will occupy the flats shortly to be built under the proposed development by Fairview Homes.

I therefore again repeat my request that this proposal be rejected.

There is currently a major problem in the Honeypot Lane/Queensbury Station area with antisocial behaviour due to large groups of people congregating and drinking around gathering places in the area, quite often though to quite late at night. The last thing this area needs is more retail of alcohol during the evening hours.

This page is intentionally left blank

Morrisons Filling Station Honeypot Lane NW9

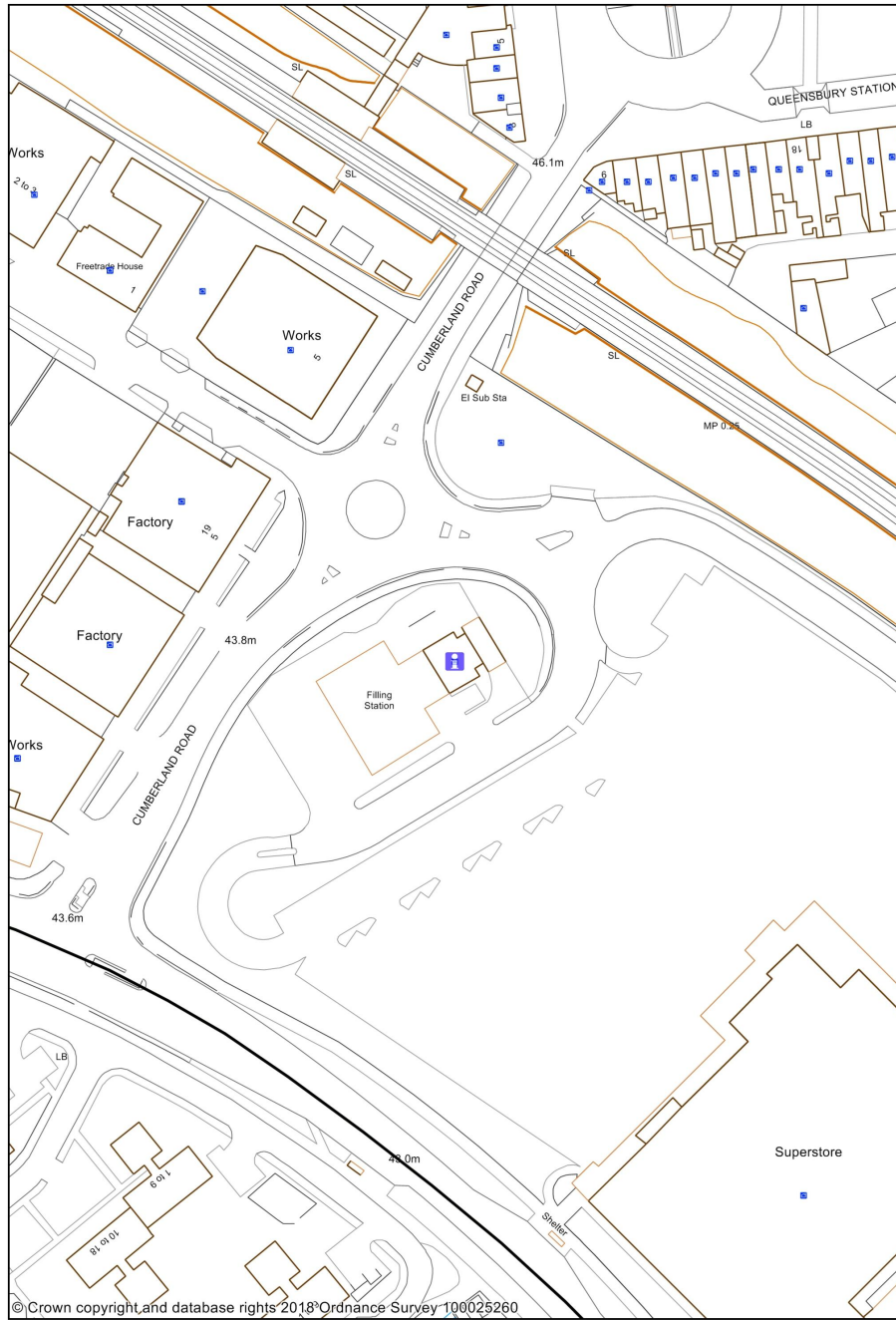

1:1250

0 0.02 0.04 kilometres



Brent

This page is intentionally left blank

LICENSING ACT 2003

Application for a Variation to a Premises Licence

1. The Application

Name of Applicant:	Hamida Moalin
Name & Address of Premises:	Sahrah Lounge 5-7 Wembley Hill Road HA9 8AF
Applicants Agent:	

1. Application

The application is to vary the licence to extend the hours for:

Live Music and Performance of Dance from 20:00hrs to 05:00hrs Friday & Saturday.

Recorded Music from 17:00hrs to 03:00hrs Sunday to Thursday and 20:00hrs to 05:00hrs Friday & Saturday.

Late Night Refreshment from 12:00hrs to 03:00hrs Sunday to Thursday and from 12:00hrs to 05:00hrs Friday & Saturday.

Opening hours from 11:00hrs to 03:00hrs Sunday to Thursday and from 11:00hrs to 05:00hrs Friday & Saturday.

2. Background

The premises are currently licensed for:

Live Music and Dance from 19:00hrs to 00:00hrs Friday & Saturday

Recorded Music from 17:00hrs to 23:00hrs Sunday to Thursday and 19:00hrs to 00:00hrs Friday & Saturday

Late Night Refreshment from 23:00hrs to 23:30hrs Sunday to Thursday and 23:00hrs to 00:00hrs Friday and Saturday.

Opening hours from 11:00hrs to 23:30hrs Sunday to Thursday and 11:00hrs to 00:30hrs Friday & Saturday.

3. Promotion of the Licensing Objectives

See page 11 of the application

4. Relevant Representations

Representations were received and agreed from the Noise Team, representations remain outstanding from the Police and Licensing Officers

5. Interested Parties

None

6. Policy Considerations

Paragraph Nos: 8.1 – 8.4

8.1 Where responsible authorities and interested parties do not raise any relevant representations regarding the application made to the council, the council will grant the licence or certificate subject only to the conditions that are consistent with the operating schedule or club operating schedule and any mandatory conditions prescribed in the Act itself.

8.2 Where responsible authorities and interested parties raise relevant representations, the council may, if it is satisfied at a hearing or otherwise, impose conditions where considered necessary for the promotion of the licensing objectives.

8.3 Any conditions attached by the council or submitted by the applicant must focus on the direct impact of the activities taking place at licensed premises, on those attending the premises and residents and persons working in the area.

8.4 Any conditions attached to licences will be tailored to the individual needs, style and characteristics of the particular premises and events concerned and will be drawn from a 'model pool of conditions' (where appropriate) to the particular premises.

7. Associated Papers

- A. Application Form
- B. Police Representation
- C. Licensing Representation
- D. Noise Team Rep & Withdrawal
- E. Copy of Licence
- F. OS Map



07 SEP 2018

APPLICATION TO VARY A PREMISES LICENCE

Application to vary a premises licence
under The Licensing Act 2003

PLEASE READ THE FOLLOWING INSTRUCTIONS FIRST

Before completing this form please read the guidance notes at the end of the form.
If you are completing this form by hand please write legibly in block capitals. In all cases ensure that your answers are inside the boxes and written in black ink. Use additional sheets if necessary.
You may wish to keep a copy of the completed form for your records.

I/We.....Hamida Moalin.....

..... [insert name of applicant(s)] being the
premises licence holder, apply to vary a premises licence under section 34 of the Licensing
Act 2003 for the premises described in Part 1 below

Premises licence number

223223095

Part 1 – Premises Details

Postal address of premises or, if none, ordnance survey map reference or description

5-7 Wembley hill Road.
HA9 8AF

Post Town

London

Post Code

HA9 8AF

Telephone number at premises (if any)

020 899 8876

Non-domestic rateable value of premises

£ 28,000

Part 2 - Applicant details

Daytime contact telephone number			
E-mail address (optional)			
Current postal address if different from premises address			
Post Town		Post Code	

Part 3 - Variation

Please tick ✓ Yes

Do you want the proposed variation to have effect as soon as possible?

☒

If not do you want the variation to take effect from

Day Month Year

--	--	--	--	--	--	--	--

Do you want the proposed variation to have effect in relation to the introduction of the late night levy? (Please see guidance note 1)

☐ Yes

☐ No

Please describe briefly the nature of the proposed variation (Please see guidance note 2)

We would like to get
our old hours back.
This variation only concerns
hours.

If your proposed variation would mean that 5,000 or more people are expected to attend the premises at any one time, please state the number expected to attend

--

Part 4 – Operating Schedule

Please complete those parts of the Operating Schedule below which would be subject to change if this application to vary is successful.

Please tick ✓ Yes

Provision of regulated entertainment (please see guidance note 3)

- | | | |
|----|-------------------------------------------------------------------------------------------------------------|-------------------------------------|
| a) | plays (if ticking yes, fill in box A) | <input type="checkbox"/> |
| b) | films (if ticking yes, fill in box B) | <input type="checkbox"/> |
| c) | indoor sporting events (if ticking yes, fill in box C) | <input type="checkbox"/> |
| d) | boxing or wrestling entertainment (if ticking yes, fill in box D) | <input type="checkbox"/> |
| e) | live music (if ticking yes, fill in box E) | <input checked="" type="checkbox"/> |
| f) | recorded music (if ticking yes, fill in box F) | <input checked="" type="checkbox"/> |
| g) | performances of dance (if ticking yes, fill in box G) | <input checked="" type="checkbox"/> |
| h) | anything of a similar description to that falling within (e), (f) or (g)
(if ticking yes, fill in box H) | <input type="checkbox"/> |

Provision of late night refreshment (if ticking yes, fill in box I)



Sale by retail of alcohol (if ticking yes, fill in box J)



In all cases complete boxes K, L and M

A

Plays Standard days and timings (please read guidance note 8)			Will the performance of a play take place indoors or outdoors or both – please tick [✓] (please read guidance note 4).	Indoors	
				Outdoors	
				Both	
Day	Start	Finish			
Mon			<u>Please give further details here</u> (please read guidance note 5)		
Tue					
Wed			<u>State any seasonal variations for performing plays</u> (please read guidance note 6)		
Thur					
Fri			<u>Non standard timings. Where you intend to use the premises for the performance of plays at different times to those listed in the column on the left, please list</u> (please read guidance note 7)		
Sat					
Sun					

B

Films Standard days and timings (please read guidance note 8)			Will the exhibition of films take place indoors or outdoors or both – please tick [✓] (please read guidance note 4).	Indoors	
				Outdoors	
				Both	
Day	Start	Finish			
Mon			<u>Please give further details here</u> (please read guidance note 5)		
Tue					
Wed			<u>State any seasonal variations for the exhibition of films</u> (please read guidance note 6)		
Thur					
Fri			<u>Non standard timings. Where you intend to use the premises for the exhibition of films at different times to those listed in the column on the left, please list</u> (please read guidance note 7)		
Sat					
Sun					

C

Indoor sporting events Standard days and timings (please read guidance note 8)			Please give further details (please read guidance note 5)
Day	Start	Finish	State any seasonal variations for indoor sporting events (please read guidance note 6)
Mon			
Tue			
Wed			Non standard timings. Where you intend to use the premises for indoor sporting events at different times to those listed in the column on the left, please list (please read guidance note 7)
Thur			
Fri			
Sat			
Sun			

D

Boxing or wrestling entertainments Standard days and timings (please read guidance note 8)			Will the boxing or wrestling entertainment take place indoors or outdoors or both – please tick [✓] (please read guidance note 4).	
Day	Start	Finish	Indoors	
			Outdoors	
			Both	
Mon			Please give further details here (please read guidance note 5)	
Tue				
Wed			State any seasonal variations for boxing or wrestling entertainment (please read guidance note 6)	
Thur				
Fri			Non standard timings. Where you intend to use the premises for boxing or wrestling entertainment at different times to those listed in the column on the left, please list (please read guidance note 7)	
Sat				
Sun				

E

Live Music Standard days and timings (please read guidance note 8)			Will the performance of live music take place indoors or outdoors or both – please tick [✓] (please read guidance note 4)		Indoors <input checked="" type="checkbox"/>
					Outdoors <input type="checkbox"/>
					Both <input type="checkbox"/>
Day	Start	Finish	<u>Please give further details here</u> (please read guidance note 5)		
Mon					
Tue					
Wed			<u>State any seasonal variations for the performance of live music</u> (please read guidance note 6) Bank holidays 8pm - 5am		
Thur					
Fri	8pm	5am	<u>Non standard timings. Where you intend to use the premises for the performance of live music at different times to those listed in the column on the left, please list</u> (please read guidance note 7) Bank holidays and new years		
Sat	8pm	5am			
Sun					

F

Recorded music Standard days and timings (please read guidance note 8)			Will the playing of recorded music take place indoors or outdoors or both – please tick [✓] (please read guidance note 4)		Indoors <input checked="" type="checkbox"/>
					Outdoors <input type="checkbox"/>
					Both <input type="checkbox"/>
Day	Start	Finish	<u>Please give further details here</u> (please read guidance note 5)		
Mon	5pm	3am			
Tue	5pm	3am			
Wed	5pm	3am	<u>State any seasonal variations for playing recorded music</u> (please read guidance note 6)		
Thur	5pm	3am			
Fri	8pm	8pm	<u>Non standard timings. Where you intend to use the premises for the playing of recorded music entertainment at different times to those listed in the column on the left, please list</u> (please read guidance note 7) Bank holidays and new years -		
Sat	5pm	8pm			
Sun	5pm	3am			

I

Late night refreshment Standard days and timings (please read guidance note 8)			Will the provision of late night refreshment take place indoors or outdoors or both – please tick (✓) (please read guidance note 4).	Indoors <input checked="" type="checkbox"/>
				Outdoors <input type="checkbox"/>
				Both <input type="checkbox"/>
Day	Start	Finish	Please give further details here (please read guidance note 5) We will not be serving alcohol This is only for our eating customers.	
Mon	12am	3am		
Tue	12am	3am	State any seasonal variations for the provision of late night refreshment (please read guidance note 6)	
Wed	12am	3am		
Thur	12am	3am		
Fri	12am	5am	Non standard timings. Where you intend to use the premises for the provision of late night refreshment at different times, to those listed in the column on the left, please list (please read guidance note 7) Bank holidays 12am - 5am	
Sat	12am	5am		
Sun	12am	3am		

J

Supply of alcohol Standard days and timings (please read guidance note 8)			Will the supply of alcohol be for consumption (Please tick box ✓) (please read guidance note 9)	On the premises <input type="checkbox"/>
				Off the premises <input type="checkbox"/>
				Both <input type="checkbox"/>
Day	Start	Finish	State any seasonal variations for the supply of alcohol (please read guidance note 6)	
Mon				
Tue			Non-standard timings. Where you intend to use the premises for the supply of alcohol at different times to those listed in the column on the left, please list (please read guidance note 7)	
Wed				
Thur				
Fri				
Sat				
Sun				

IN ALL CASES PLEASE COMPLETE K, L, & M BELOW

G

Performances of dance Standard days and timings (please read guidance note 8)			Will the performance of dance take place indoors or outdoors or both – please tick [✓] (please read guidance note 4).	Indoors	
				Outdoors	
				Both	
Day	Start	Finish	<u>Please give further details here</u> (please read guidance note 5)		
Mon					
Tue					
Wed			<u>State any seasonal variations for the performance of dance</u> (please read guidance note 6)		
Thur					
Fri	8PM	5AM			
Sat	8PM	5AM	<u>Non standard timings. Where you intend to use the premises for the performance of dance entertainment at different times to those listed in the column on the left, please list</u> (please read guidance note 7)		
Sun					

H

Anything of a similar description to that falling within (e), (f) or (g) Standard days and timings (please read guidance note 8)			Please give a description of the type of entertainment you will be providing					
						Will this entertainment take place indoors or outdoors or both – please tick [✓] (please read guidance note 4).		
Day	Start	Finish	Outdoors					
Mon			Both					
Tue			<u>Please give further details here</u> (please read guidance note 5)					
Wed								
Thur								
Fri			<u>State any seasonal variations for entertainment of a similar description to that falling within (e), (f) or (g)</u> (please read guidance note 6)					
Sat								
Sun								
			<u>Non standard timings. Where you intend to use the premises for the entertainment of similar description to that falling within (e), (f) or (g) at different times to those listed in the column on the left, please list</u> (please read guidance note 7)					

K

Please highlight any adult entertainment or services, activities, other entertainment or matters ancillary to the use of the premises that may give rise to concern in respect of children (please read guidance note 10)

None.

L

Hours premises are open to the public
Standard days and timings
(please read guidance note 8)

Day	Start	Finish
Mon	11am	3am
Tue	11am	3am
Wed	11am	3am
Thur	11am	3am
Fri	11am	3am
Sat	11am	5am
Sun	11am	3am

State any seasonal variation (please read guidance note 6)

Bank holidays, & and new years eve.

Non-standard timings. Where you intend the premises to be open to the public at different times to those listed in the column on the left, please list (please read guidance note 7)

Bank holidays and new years.

Please identify those conditions currently imposed on the licence which you believe could be removed as a consequence of the proposed variation you are seeking

None
only change is timing

Please tick ☒ Yes

• I have enclosed the premises licence



• I have enclosed the relevant part of the premises licence



If you have not ticked one of these boxes please fill in reasons for not including the licence, or part of it, below

Reasons why I have failed to enclose the premises licence or relevant part of premises licence

M Describe any additional steps that you intend to take to promote the four licensing objectives as a result of the proposed variation:

a) General – all four licensing objectives (b, c, d, e) (please read guidance note 11)

→ CCTV
→ Security
→ fire exits
→ instructions for customers not to hang out outside

b) The prevention of crime and disorder

→ CCTV
→ call the police
→ hire security
→ ~~host over~~ Ban customers that cause problems.

c) Public safety

→ hire security
→ Well lit fire exits
→ CCTV

d) The prevention of public nuisance

→ CCTV.
→ Security
→ clear instructions for customers to leave.

e) The protection of children from harm

→ Ensure Property is child friendly/safe
→ Remove obstacles that children can fall over.

Please tick ✓ Yes

- I have made or enclosed payment of the fee ☒
- I have not made or enclosed payment of the fee because this application has been made in relation to the introduction of the late night levy ☒
- I have sent copies of this application and the plan to responsible authorities and others where applicable ☒
- I understand that I must now advertise my application ☒
- I have enclosed the premises licence or relevant part of it or explanation ☒
- I understand that if I do not comply with the above requirements my application will be rejected ☒

IT IS AN OFFENCE, UNDER SECTION 158 OF THE LICENSING ACT 2003, TO MAKE A FALSE STATEMENT IN OR IN CONNECTION WITH THIS APPLICATION. THOSE WHO MAKE A FALSE STATEMENT MAY BE LIABLE ON SUMMARY CONVICTION TO A FINE OF ANY AMOUNT.

Part 5 – Signatures (please read guidance note 12)

Signature of applicant (the current premises licence holder) or applicant's solicitor or other duly authorised agent. (Please read guidance note 13). If signing on behalf of the applicant please state in what capacity.

Signature M. A. H. D.

Date 04-09-18

Capacity

Where the premises licence is jointly held signature of 2nd applicant (the current premises licence holder) or 2nd applicant's solicitor or other authorised agent. (Please read guidance note 14). If signing on behalf of the applicant please state in what capacity.

Signature

Date

Capacity

Contact name (where not previously given) and postal address for correspondence associated with this application (please read guidance note 15)

Post town

Post code

Telephone number

Notes



Scale in Meters
1:100

Rev	Date	Drawn	By
A	23/07/14	Revised A	B

Project: Change of Use

Subject: Proposed Layout

Client: B-7 Werrisley Hill Road, Werrisley, H49 8AF

Drawing of: ELA3

Sheet: A

1:100

CE

0016

23/07/14

ELA Design
10 Church Lane
Werrisley
H49 8AF
01753 611111

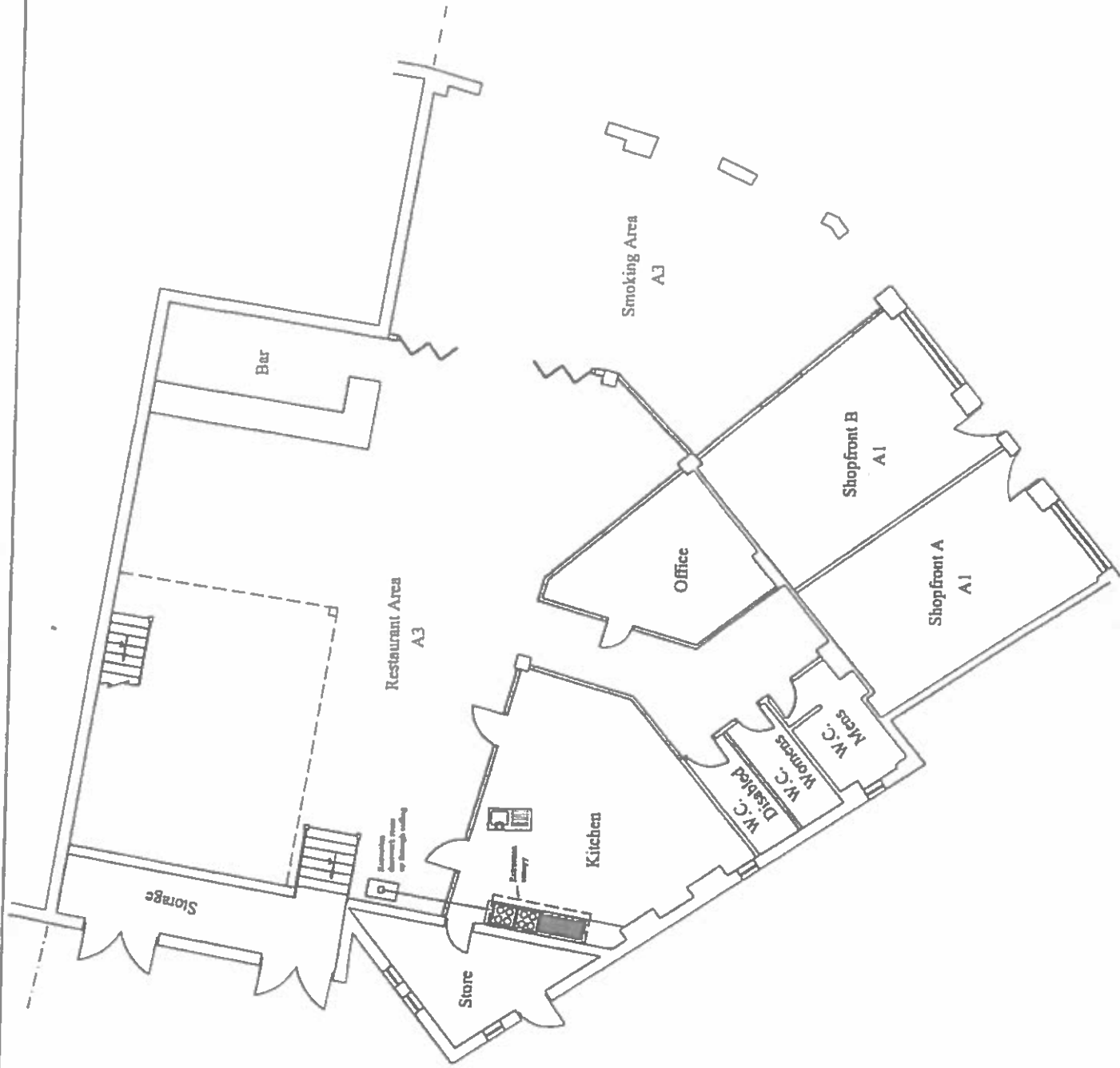

This page is intentionally left blank

Sahrah Lounge
5-7 Wembley Hill Road
Wembley
HA9 8AF

15 October 2018

Our Ref 13498

Licensing Representation to the Variation Application for the Premises License for Sahrah Lounge, 5-7 Wembley Hill Road, Wembley, HA9 8AF

I certify that I have considered the application shown above and I wish to make a representation that the likely effect of the grant of the application is detrimental to the Licensing Objectives for the reasons indicated below.

Officer: Susana Figueiredo – Licensing Inspector

An officer of the Licensing Authority, in whose area the premises are situated, who is authorised for the purposes of exercising its statutory function as a 'Responsible Authority' under the Licensing Act 2003.

The application has been made to vary the premises licence under section 34 of the Act.

Refusal of Application to Vary the Premises Licence

The current licence was reviewed in December 2016 after complaints received by Brent Council which dated back to July 2015. An application to vary the licence has now been proposed, however there is nothing in the application that indicates how the premises will be managed differently to the time when the premises were permitted to carry out extended hours and as a result was reviewed for not being managed adequately.

Until such a time that you are able to:-

- document how the premises will be run differently and/or
- evidence current business practice which demonstrates how changes have been made since the review application

the Licensing Authority have no other option other than to refuse the application for the extended hours. I believe it is fair and proportionate and would uphold the Licensing objectives in light of the previous management of the business.

Yours faithfully,



Susana Figueiredo
Licensing Inspector
Planning, Transportation & Licensing



**METROPOLITAN
POLICE**

Working together for a safer London

TERRITORIAL POLICING

Brent Police Licensing Unit

*Brent Civic Centre
Engineers Way
Wembley
Middlesex
HA9 0FJ*

Your ref:

Our ref: 01QK/ 18/53QK

Brent Borough Licensing Department

*South Harrow Police Station
74 Northolt Road
Harrow
HA2 0DN*

Tel: 020 8733 4530

Email: damien.smith@met.police.uk

Web: www.met.police.uk

Date: 11th October 2018

Police representation to the Premises Licence Variation Review Application for 'SAHRAH Lounge' 5-7 Wembley Hill Road, Wembley, HA9 8AF.

Officer: Damien Smith
Licensing Sergeant PS 53QK

An officer of the Metropolitan Police, in whose area the premises are situated, who is authorised for the purposes of exercising its statutory function as a 'Responsible Authority' under the Licensing Act 2003.

The application has been made for a variation of the premises licence under section 34 of the act.

I certify that I have considered the application shown above and I wish to make representations that the likely effect of the grant of the application is detrimental to the Council's Licensing Objectives for the reasons indicated below. I am of the opinion that the risk to the Council's objectives can be mitigated by rejecting the requested variation regarding extended opening hours.

The Police representations are concerned with the prevention crime and disorder and public nuisance.

The current premises licence number for 5-7 Wembley Hill Road, Wembley is 223223095. Police dealt with the initial application for the premise Licence received by Brent Police Licensing team on 9th November 2014. This applicant and premises licence holder are one of the same: Ms Hamida Moalin, of 296 Harrow Road, Wembley, HA9 6LJ.

In 2015 and 2016 the premises concerned was linked to anti-social behaviour and complaints from residents of noise nuisance both internally and externally. As a consequence of the complaints the venue was taken to a review of its licence and the committee decided that the licence be suspended for 2 months to enable the licence holder to bring the management and maintenance of the premises up to a required standard. Furthermore after the suspension ended the opening hours were amended

and currently remain as Sunday to Thursday 1100 until 2330 hours and Friday and Saturday 1100 until 0030 hours as agreed by the committee.

The amended hours implemented have significantly impacted 'positively' on the amount of nuisance caused or linked to the venue.

In 2017 no temporary event notices (TENS) took place at the premises.

To date, six TENS have been applied for in 2018, four of which the applications indicated 70 guests and two of which indicated 50 guests were expected to attend including staff. Five of the applications indicated 3 x SIA staff and 1 indicated 4 x SIA staff. Each of the TEN requested an extension of hours until 0400 hours. The temporary events have all been private parties or celebrations which would suggest 'invitees only'. The Invitees wouldn't necessarily consist of regular customers to the venue.

This full variation application is asking to remove the conditions imposed by the committee following the last review. The hours requested by the applicant are Sunday to Thursday 1100 hours until 0300 hours and Friday and Saturday 1100 hours until 0500 hours.

On Wednesday 3rd October 2018, I visited the restaurant accompanied by PC McDonald at 1600 hours in uniform. To the right of the main entrance (Externally) there was an A3 blue notice displaying the proposed new hours applied for with the local authority. In the venue I met with the applicant who was welcoming and showed us around her restaurant area and the upstairs section. The applicant pointed out that business was slow and that the request for extending the opening hours was based on the Somali communities demand.

For clarity, the applicant pointed out two ground floor areas, one at the front of the venue incorporating the main entrance and a second area that has a glass partition set back from the front that consists of dining area. It is the larger area that the applicant has held temporary events beyond the 0030 hours. I asked what happens with the regular customers at the front, and the applicant indicated that they would be kept separate from the parties/functions in the rear section. The applicant informed me that it was difficult to take bookings from customers in advance based on the limitations of TENS. The applicant indicated that all parties/functions held at the venue would be family orientated and by invite or ticket only. I asked whether the front would operate to the same hours it currently does or if the front would also remain open to the public utilising the extended hours if authorised by the committee. The applicant expressed she would like the whole restaurant to remain open to the extended hours applied for. At this point the applicant also indicated that she doubted staying open until 0500 hours every time. I asked the necessity for 0500 hours as opposed to 0200 hours or 0300 hours to which the applicant again said she knew her customers' requirements and demand.

The applicant voluntarily showed me cctv from Friday September 28th 2018 at 0030 hours which clearly showed no customers in the venue as per current license conditions. I note that the current licence has 29 conditions. These conditions were also set with each TEN by the applicant. The applicant stated that the business no longer provides shisha and there was no evidence of equipment in the venue. Of note there was no signage at the exit requesting that patrons be quiet or respectful to neighbours as per **Annex 2 - condition 18** and there was no signage on display at the entrance regarding the licensees admission policy and use of search by staff – **annex 2 condition 10**

The applicant informed me that she has invested heavily into the restaurant and was determined to make it work. I pointed out that some of the issues that resulted in the review in 2017 remained such as Parking, close proximity to residential properties, backing onto a service road, used by delivery vehicles and refuse collectors early in the morning. The applicant acknowledged this and insisted that was based on the customers the venue used to attract. The applicant again insisted that she was concentrating on attracting families and group parties to the venue that were older and more respectful.

The applicant referred to the temporary events that had been held and said she had learnt from them. This included using SIA door staff. The premises was broken into within the last month and the applicant stated everything was taken including paper work from the manager's office. This included the SIA door log and incident book.

In relation to the six temporary events held at the venue I am not aware of any complaints to the 999 or 101 call handling system regarding these events or any associated ASB. I am concerned that the venue being open until 0300 hours Sunday through until Thursday and then until 0500 hours Friday and Saturday will afford an opportunity for noise nuisance and reported ASB to reappear and it is through the TENs process applied for, the venue has been used appropriately – i.e. an event outside that of the normal business held at the venue.

The applicant also wishes to open until 0500 hours on bank holidays and New Year's Eve. There is no other business in the vicinity that will be open that late and the residents have been problem free since the amended hours authorised by the committee. Should the committee authorise the new extended hours I request that new conditions are set in addition to the current 29 listed.

The conditions that Police require to be added to the Premises Licence are listed below:

1. Anytime the premises are open to the public, for licensable activities after 0030hrs, the customers will be attending a pre-booked event in the rear function room.
2. The licensee upon accepting bookings implements a system whereby she obtains valid photo Identification and proof of address for the person responsible for the attending party/function attendees.
3. The front area by the main entrance remain open at the current hours Sunday through Thursday 2330 hours with Friday and Saturday until 0030 hours. This facilitates the control of the private function/party and who is at the venue and avoids any temptation for regular customers to join the party.

Yours Sincerely,

Damien Smith 53QK
Licensing Constable Brent Police

This page is intentionally left blank

From: DAMIEN.J.Smith@met.pnn.police.uk [mailto:DAMIEN.J.Smith@met.pnn.police.uk]
Sent: 16 October 2018 12:22
To:
Cc: Legister, Linda <Linda.Legister@brent.gov.uk>; Business Licence <business.licence@brent.gov.uk>
Subject: RE: CONSULT - Variation - Sahrah Lounge, 5-7 Wembley Hill Road, HA9 8AF - 13498

Good Afternoon,

Thank you for your reply.

I have checked the TENs for your premises and apologise that I missed one event in December 2017. This was a party on the 3rd December. I am also aware of the New Year's Eve TEN which was refused.

I cannot find any other TEN for 2017. If you have any further information to hand for any other events held please forward this to me.

The red car park at Wembley you refer to charges customers £1 per hour and this in effect for 24 Hours, 7 days a week.

From a Police perspective the conditions mentioned on the representations remain in place as submitted to the Local authority,

Kind regards

Damien Smith 53QK

From: hi issa
Sent: 12 October 2018 20:29
To: Smith Damien J - QK
Cc: business.licence@brent.gov.uk
Subject: Re: CONSULT - Variation - Sahrah Lounge, 5-7 Wembley Hill Road, HA9 8AF - 13498

Dear Damien,

Thank you for the quick response. I think that was a fair assessment of the situation. However, I would like to point out a few things.

1. In 2017, Hiddo Restaurant made a number of TEN applications, and the events took place without any issues/complaints.
2. In your letter you write that the invitees would not necessarily be our regular customers. While this is true in the strict sense, as there is no way of guaranteeing that every single person coming would be a regular customers, the vast majority of the people coming are our customers. Our customers are 90% of the time people that have come before, and our lifeline is people who come at least three times a week. This is who, our events (if there were any) would be targeted at. This means that we know these people very well. This is the same client base asking for later opening times.
3. The change we are requesting in opening times is to serve food later, as well as to hold private events. Our client base, we have found, particularly in the weekend, want to come

and eat later in the evenings, and needing to close so early forces our customers to go elsewhere.

4. We have found a solution for the parking problem, which you rightfully mentioned. Red Car Park, which is a few minutes walk is open 24 hours. We've been insisting our customers use it and has been displayed.
5. We have not displayed a notice asking our customers to respect our neighbours and to not congregate in the area.

In relation to the three conditions that will be required by the police. We have no problem whatsoever with the second condition, setting up a system for recording valid identification of the person responsible for attendees of the event. We do however object to the first and second conditions.

This is because we do not always have bookings. We need to operate longer hours and all of our customers are people that like to eat at night. As such, agreeing to the first condition would require us to close down early any time we did not have a booking. The business is really struggling at the moment, and we could really benefit from serving food later to our customers. With regards to the third condition, we would need to use the front area to serve food, and should there be an event in the rear area, we could have security at the front of the rear area.

Regards,

Hamida

From: DAMIEN.J.Smith@met.police.uk

Sent: 12 October 2018 15:51

To:

Cc: business.licence@brent.gov.uk

Subject: CONSULT - Variation - Sahrah Lounge, 5-7 Wembley Hill Road, HA9 8AF - 13498

Dear Ms Moalin,

Thank you once again for showing me around your premises.

Please find the Police representations regarding your application/variation

Kind regards

Damien Smith 53QK

Regulatory Services MEMORANDUM

LICENSING CONSULTATION -INTERNAL MEMO

To: Hamida Moalin
From: Jason Nelson
Cc:
Date: 10/10/2018
Premises: 5-7 Wembley Hill Road, Wembley, HA9 8AF
Type of Application: Variation
Reference: 13498
Licensing activities: Extend operational hours.

Dear Ms Moalin,

I would like to confirm that I have considered the above proposal with regard to the prevention of public nuisance.

On behalf of Regulatory Services (Environmental Health) I would like to make representations to the Variation.

On the following grounds:

That the proposed operating hours are inappropriate due to the close proximity of residential dwellings. The noise caused by patrons exiting the premises and finding suitable transport home is likely to be detrimental to the residential amenity.

The operating schedule does not address the prevention of public nuisance from:

Noise from patrons exiting the premises.

Objection

Nuisance Control objects to the proposed hours as there is not suitable parking for patrons who double parks outside on double yellow lines and causes obstructions to large vehicles trying to pass.

As the property is now a restaurant the proposed hours will give rise to loitering around when smoking and causing public nuisance.

Informative

I would recommend the following alterations/conditions to the operating schedule:

The applicant is to provide evidence of sound proofing the premises that will avoid noise breakout from amplified & live music, so local residents will not be affected.

Conditions if granted

Patrons entering/exiting premises.

Signs should be displayed instructing patrons to respect the neighbours and behave in a courteous manor

A licensed door supervisor will be positioned on the exit door to ensure, as far as reasonably practical, that patrons leave in a quiet and respectable manor

Operating hours

That the premises closes no later than midnight Sunday to Thursday and 2am Friday & Saturday.

From: Nelson, Jason
Sent: 19 October 2018 16:28
To: 'hi issa'
Cc: Murray, Gillian <gillian.murray@brent.gov.uk>; Business Licence <business.licence@brent.gov.uk>; Barrett, Jennifer <Jennifer.Barrett@brent.gov.uk>
Subject: RE: Reference: 13498

Dear Hamida,

I will now withdraw my representations as you have agreed the conditions.

Kind Regards

Jason Nelson
Enforcement Officer

From: hi issa
Sent: 19 October 2018 16:20
To: Nelson, Jason
Cc: Murray, Gillian ; Business Licence
Subject: Re: Reference: 13498

Dear Jason,

Thank you for the swift follow up. Yes, I agree to those terms.
Regards,
Hamida

From: Nelson, Jason <Jason.Nelson@brent.gov.uk>
Sent: 19 October 2018 16:14:02
To:
Cc: Murray, Gillian; Business Licence
Subject: RE: Reference: 13498

Dear Hamida,

I write as a follow up to our conversation earlier today regarding the variation submitted.

As agreed, you stated you are willing to accept the hours I suggested for operation of the restaurant for licensable activities.

Sunday – Thursday (Regulated entertainment) – 17:00 to 01:00. (Friday – Saturday from 17:00 to 03:00).

Sunday – Thursday (Live Music) Nothing after 23:00 unless applying for T.E.N. (Friday – Saturday from 20:00 to 03:00).

Late Night refreshments: Sunday – Thursday from 23:00 to 01:00. Friday – Saturday from 23:00 to 03:00.

Please reply via email stating whether you agree or disagree to the above condition that will be attached to your application.

Kind Regards

Jason Nelson
Enforcement Officer

.....

From: hi issa
Sent: 11 October 2018 18:10
To: ens.noise@brent.gov.uk
Subject: Fw: Reference: 13498

Dear Sir/Madam,

I hope this email finds you well. We have tried to, to the best of our abilities, to answer all the questions/points made by your letter. If you have any other questions, please ask.

Nuisance Control objects to the proposed hours as there is not suitable parking for patrons who double parks outside on double yellow lines and causes obstructions to large vehicles trying to pass.

Our customers are currently using Red car park which is 24 hours and less than 3 minutes walk. Parking would therefore not be a problem. Not only have we been encouraging our customers to use this car park but they have been given very serious instruction on where they cannot park (around the side and the back, and especially not at the front as this is illegal).

As the property is now a restaurant the proposed hours will give rise to loitering around when smoking and causing public nuisance.

The restaurant is divided into two sections. The main section of the restaurant and a section for drinking and snacks. We ask that all of our customers wait in the snacks section as they wait for their ride home. This will ensure that not one customer waits outside the building for the car to pick them up. All staff have been given training on how to prevent customers from loitering in the area. And we enforce this with the utmost seriousness. Furthermore, the majority of our customers are families and couples on dates, neither group is likely to loiter in the areas, in any case, particularly not at night.

The applicant is to provide evidence of sound proofing the premises that will avoid noise breakout from amplified & live music, so local residents will not be affected.

This issue has been raised by the environmental authorities in the past, in fact, I believe that someone from your office (Mr Wood) came in some 18 months ago, perhaps longer, to see the noise leakage, if there was any. It is my understanding that there was not. That said, we do not have sound proofing evidence this is because it was done by our builders. It was so much cheaper for it to be done in-house than contract it out. It is also my understanding that no complaints have been made about Hiddo Restaurant inside or outside noise since we have been open. And we play music regularly. This, I hope, speaks volumes (mind the pun) about how great the sound proofing is.

Regards,
Hamida



Brent

REGENERATION AND GROWTH
REGULATORY SERVICES
BRENT CIVIC CENTRE
ENGINEERS WAY
WEMBLEY
HA9 0FJ

TEL: 020 8937 5359
EMAIL: business.licence@brent.gov.uk



London Borough of Brent Premises Licence

PART A

This Premises Licence was granted by Brent Council, Licensing Authority for the area of the Borough of Brent under the Licensing Act 2003.

Signed....*Alister Choudhury*
Director of Environment and Neighbourhood

Date: 23 November 2017

Licence number 223223095

Licence start date: 01/01/2015

Part 1 - Premises Details

SAHRAH LOUNGE, 5-7 Wembley Hill Road, Wembley, HA9 8AF

Licensable activities and the times authorised by this licence

Live Music:

Day	Start Time	End Time
Friday	19:00	00:00
Saturday	19:00	00:00

Recorded Music:

Day	Start Time	End Time
Monday	17:00	23:00
Tuesday	17:00	23:00
Wednesday	17:00	23:00
Thursday	17:00	23:00
Friday	19:00	00:00
Saturday	19:00	00:00
Sunday	17:00	23:00

Performances of Dance:

Day	Start Time	End Time
Friday	19:00	00:00
Saturday	19:00	00:00

Provision of Entertainment Facilities for Dancing:

Day	Start Time	End Time
Friday	19:00	00:00
Saturday	19:00	00:00

Provision of Late Night Refreshment:

Day	Start Time	End Time
Monday	23:00	23:30
Tuesday	23:00	23:30
Wednesday	23:00	23:30
Thursday	23:00	23:30
Friday	23:00	00:00
Saturday	23:00	00:00
Sunday	23:00	23:30

The Opening Hours of the Premises:

Day	Start Time	End Time
Monday	11:00	23:30
Tuesday	11:00	23:30
Wednesday	11:00	23:30
Thursday	11:00	23:30
Friday	11:00	00:30
Saturday	11:00	00:30
Sunday	11:00	23:30

Part 2

Details of Holder of Premises Licence:

Name: Hamida Moalin

Address: [REDACTED]

Details of Designated Premises Supervisor:

Not applicable

Annexe 1 - Mandatory Conditions

No Irresponsible Drinks Promotions

(1) The responsible person must ensure that staff on relevant premises do not carry out, arrange or participate in any irresponsible promotions in relation to the premises.

(2) In this paragraph, an irresponsible promotion means any one or more of the following activities, or substantially similar activities, carried on for the purpose of encouraging the sale or supply of alcohol for consumption on the premises—

(a) games or other activities which

require or encourage,

or are designed to require or encourage, individuals to— (i) drink a quantity of alcohol within a time limit (other than to drink alcohol sold or supplied on the premises before the cessation of the period in which the responsible person is authorised to sell or supply alcohol), or (ii) drink as much alcohol as possible (whether within a time limit or otherwise);

(b) provision of unlimited or unspecified quantities of alcohol free or for a fixed or discounted fee to the public or to a group defined by a particular characteristic in a manner which carries a significant risk of undermining a licensing objective;

(c) provision of free or discounted alcohol or any other thing as a prize to encourage or reward the purchase and consumption of alcohol over a period of 24 hours or less in a manner which carries a significant risk of undermining a licensing objective;

(d) selling or supplying alcohol in association with promotional posters or flyers on, or in the vicinity of, the premises which can reasonably be considered to condone, encourage or glamorise anti-social behaviour or to refer to the effects of drunkenness in any favourable manner;

(e) dispensing alcohol directly by one person into the mouth of another (other than where that other person is unable to drink without assistance by reason of disability).

Free Water

The responsible person shall ensure that free potable water is provided on request to customers where it is reasonably available.

Age Verification Policy

- (1) The premises licence holder or club premises certificate holder must ensure that an age verification policy is adopted in respect of the premises in relation to the sale or supply of alcohol.
- (2) The designated premises supervisor in relation to the premises licence must ensure that the supply of alcohol at the premises is carried on in accordance with the age verification policy.
- (3) The policy must require individuals who appear to the responsible person to be under 18 years of age (or such older age as may be specified in the policy) to produce on request, before being served alcohol, identification bearing their photograph, date of birth and either—
 - (a) a holographic mark, or
 - (b) an ultraviolet feature.

Small Measures to be Available

The responsible person must ensure that—

- (a) where any of the following alcoholic drinks is sold or supplied for consumption on the premises (other than alcoholic drinks sold or supplied having been made up in advance ready for sale or supply in a securely closed container) it is available to customers in the following measures—
 - (i) beer or cider: ½ pint;
 - (ii) gin, rum, vodka or whisky: 25 ml or 35 ml; and
 - (iii) still wine in a glass: 125 ml;
- (b) these measures are displayed in a menu, price list or other printed material which is available to customers on the premises; and
- (c) where a customer does not in relation to a sale of alcohol specify the quantity of alcohol to be sold, the customer is made aware that these measures are available

Minimum Price of Alcohol

1. A relevant person shall ensure that no alcohol is sold or supplied for consumption on or off the premises for a price which is less than the permitted price.
2. For the purposes of the condition set out in paragraph 1—
 - (a) —duty II is to be construed in accordance with the Alcoholic Liquor Duties Act 1979;
 - (b) —permitted price II is the price found by applying the formula—

$$P = D + (D \times V)$$

where—

- (i) P is the permitted price,
- (ii) D is the amount of duty chargeable in relation to the alcohol as if the duty were charged on the date of the sale or supply of the alcohol, and

(iii) V is the rate of value added tax chargeable in relation to

the alcohol as if the value added tax were charged on the date of the sale or supply of the alcohol;

(c) —relevant person II means, in relation to premises in respect of which there is in force a premises licence—

(i) the holder of the premises licence,

(ii) the designated premises supervisor (if any) in respect of such a licence, or

(iii) the personal licence holder who makes or authorises a supply of alcohol under such a licence;

(d) —relevant person II means, in relation to premises in respect of which there is in force a club premises certificate, any member or officer of the club present on the premises in a capacity which enables the member or officer to prevent the supply in question; and

(e) —valued added tax II means value added tax charged in accordance with the Value Added Tax Act 1994.

3. Where the permitted price given by Paragraph (b) of paragraph 2 would (apart from this paragraph) not be a whole number of pennies, the price given by that sub-paragraph shall be taken to be the price actually given by that sub- paragraph rounded up to the nearest penny.

4. (1) Sub-paragraph (2) applies where the permitted price given by Paragraph (b) of paragraph 2 on a day (—the first day II) would be different from the permitted price on the next day (—the second day II) as a result of a change to the rate of duty or value added tax.

(2) The permitted price which would apply on the first day applies to sales or supplies of alcohol which take place before the expiry of the period of 14 days beginning on the second day.

Requirement for a DPS

(1) No supply of alcohol may be made under the premises licence-

(a) at a time when there is no designated premises supervisor in respect of the premises licence, or

(b) at a time when the designated premises supervisor does not hold a personal licence or their personal licence is suspended.

(2) Every supply of alcohol under the premises licence must be made or authorised by a person who holds a personal licence.

Door Supervisors and Security Staff to be Licensed by the SIA (when required)

Where the licence includes a condition that at specified times one or more individuals must be at the premises to carry out a security activity, each individual must be licensed by the Security Industry Authority, with the following exceptions:

a) premises where the premises licence authorises plays or films

b) any occasion mentioned in paragraph 8(3)(b) or (c) of Schedule 2 to the Private Security Industry Act 2001 (premises being used exclusively by a club with a club

premises certificate, under a temporary event notice authorising plays or films or under a gaming licence), or

c) any occasion within paragraph 8(3)(d) of Schedule 2 to the Private Security Industry Act 2001

Film Classification When required

(i) The admission of children to the exhibition of any film must be restricted in accordance with the recommendation of the designated film classification body unless section (ii) applies.

(ii) Where the licensing authority notifies the holder of the licence that this subsection applies the admission of children must be restricted in accordance with any recommendation made by the licensing authority.

In this section-

"children" means persons aged under 18; and

"film classification body" means the person or persons designated as the authority

under section 4 of the Video Recordings Act 1984 (c. 39) (authority to determine suitability of video works for classification).

Embedded Conditions

Not applicable

Annexe 2 - Conditions Consistent With the Operating Schedule

- 1 CCTV shall be installed to Home Office Guidance standards and maintained in a good working condition and recordings shall be kept for 31 days and shall be made available to police and authorised Officers from Brent Council.
- 2 A CCTV camera shall be installed to cover the entrance of the premises
- 3 A suitable number of door supervisors of a suitable gender mix, shall be employed from 2100 hours on any day when the premises are open to the public past midnight.
- 4 A register/log containing the names, badge number, dates & times of duty of security staff and any incidents that occur shall be kept and made available to the Police and Licensing Authority.
- 5 Door supervisors shall wear clothing that can be clearly and easily identified on CCTV.
- 6 ~~Only electronic smoking devices shall be offered for consumption on the premise.~~
- 7 Customers shall not be permitted to take open drink containers outside the premises as defined on the plan submitted to and approved by the Licensing Authority.

- 8 Customers carrying open or sealed bottles or glasses shall not be admitted to the premises
- 9 The maximum number of persons within the premises shall not exceed 100 including staff. The upstairs section of the premises, if used, shall not exceed 30.
- 10 Notices clearly explaining the licensee's policy on admission and searching shall be placed at each entrance.
- 11 A clear and unobstructed view into the premises shall be maintained at all times.
- 12 An incident log shall be kept at the premises, and made available for inspection on request to an authorised officer of Brent Council or the Police, which will record the following:
 - (a) all crimes reported to the venue
 - (b) all ejections of patrons
 - (c) any complaints received
 - (d) any incidents of disorder
 - (e) all seizures of drugs or offensive weapons
 - (f) any faults in the CCTV system or searching equipment or scanning equipment
 - (g) any visit by a relevant authority or emergency service.
- 13 A copy of the premises licence summary including the hours which licensable activities are permitted shall be visible from the outside of each entrance to the premises.
- 14 No entry or re-entry shall be permitted after 0000 hours.
- 15 On major event days at Wembley Stadium the following shall apply:
 - Customers shall not be allowed to congregate outside the premises.
 - No drinks shall be served in glass containers.
 - The DPS or deputy shall work in partnership with the Police and if necessary comply with any direction given by a senior Police Officer on duty at the event.
- 16 The Licensee shall undertake a risk assessment agreed by the Police and Licensing Authority of any significant promotion or event, using the Metropolitan Police Service Promotion/Event Risk Assessment Form (Form 696) or an equivalent and provide a copy to the Metropolitan Police and Brent Council's Licensing Unit not less than 14 days before the event is due to take place.
- 17 All furniture and soft furnishings shall comply with relevant fire safety standards
- 18 Notices asking customers to leave quietly shall be conspicuously displayed at all exits
- 19 The level of music shall be arranged so as not to cause a nuisance to local residents.
- 20 Nudity, striptease and other entertainment of an adult nature shall not be permitted on the premises
- 21 No children shall be permitted on the premises after 22:00 hours

- 22 The locks and/or flush latches on the exit doors shall be unlocked and kept free from fastenings other than push bars whilst the public are on the premises.
- 23 Any socket outlets (or other power supplies used for DJ equipment, band equipment and other portable equipment) that are accessible to performers, staff or the public shall be suitably protected by a residual current device (RCD having a rated residual operating current not exceeding 30 milliamps).
- 24 The playing of live or recorded music shall not be permitted in or for the benefit of any garden/shisha or external area of the building.
- 25 The televisions in the shisha smoking room or in any external area shall be kept on mute when in operation or turned off completely
- 26 The external areas of the building shall be used for smoking only. Premises supervisors shall actively monitor the noise levels and take appropriate measures to ensure any noise does not cause disturbance to local residents.
- 27 No noise or vibration arising from the live or recorded music played indoors, shall be detectable at any neighbouring noise sensitive premises.
- 28 When patrons leave the premises, door supervisors and/or stewards shall ensure that patrons behave in an acceptable manner and do not cause a disturbance to the local residents.
- 29 Patrons shall be discouraged from congregating in large numbers outside the premises for extended periods and should either be ushered back inside the premises or asked to move on in order to prevent congestion, noise and anti-social behaviour.

Annexe 3 - Conditions Attached After a Hearing by the Licensing Authority

Not applicable

Annexe 4 - Plans

See attached sheet.

Sahrah Lounge 5-7 Wembley Hill Road HA9 8AF

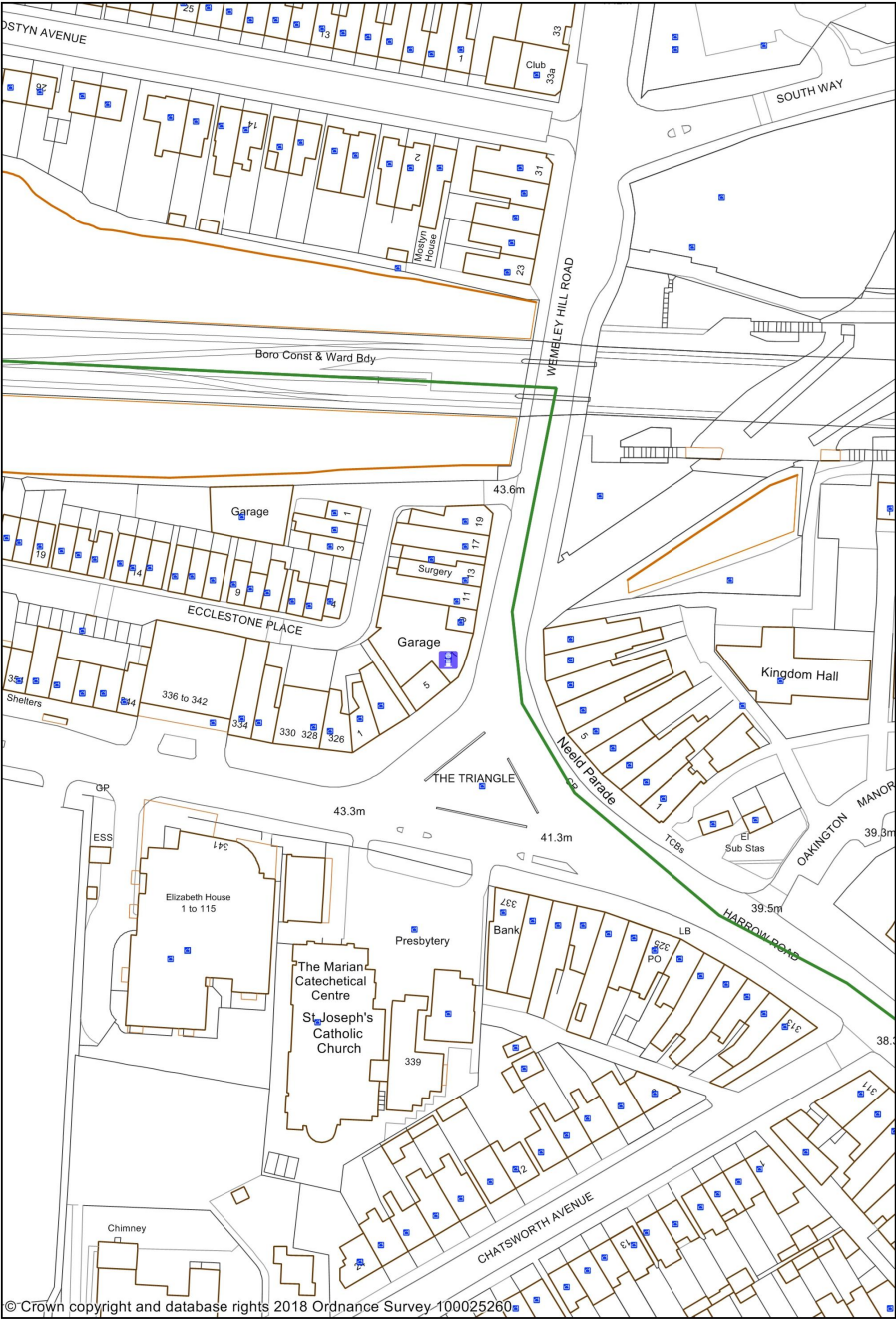

1:1250

0 0.02 0.04 kilometres



This page is intentionally left blank

LICENSING ACT 2003

Application for New Premises Licence

1. The Application

Name of Applicant:	Satyanarayan Restaurant Ltd
Name & Address of Premises:	Satyanarayan Restaurant 23-25 Queensbury Station Parade HA8 5NR
Applicants Agent:	

The application is for a new premises licence:

- 1 For Sale & Supply of alcohol from 12:00hrs to 23:00hrs Monday to Wednesday, 12:00hrs to 01:00hrs Thursday to Saturday and 12:00hrs to 00:00hrs Sunday.
Regulated Entertainment from 12:00hrs to 23:00hrs Monday to Wednesday, 12:00hrs to 01:00hrs Thursday to Saturday and 12:00hrs to 00:00hrs Sunday.
Opening hours from 12:00hrs to 23:00hrs Monday to Wednesday, 12:00hrs to 01:00hrs Thursday to Saturday and 12:00hrs to 00:00hrs Sunday.

2. Background

None

3. Promotion of the Licensing Objectives

See page 13 of the application.

4. Relevant Representations

Representations have been received and withdrawn from Licensing Officers and the Nuisance Control Team. Representations remain outstanding from the Police and Public Safety Officers.

5. Interested Parties

None

6. Policy Considerations

Paragraph Nos: 7.2 8.1 – 8.4

8.1 Where responsible authorities and interested parties do not raise any relevant representations regarding the application made to the council, the council will grant the licence or certificate subject only to the conditions that are consistent with the operating schedule or club operating schedule and any mandatory conditions prescribed in the Act itself.

8.2 Where responsible authorities and interested parties raise relevant representations, the council may, if it is satisfied at a hearing or otherwise, impose conditions where considered necessary for the promotion of the licensing objectives.

8.3 Any conditions attached by the council or submitted by the applicant must focus on the direct impact of the activities taking place at licensed premises, on those attending the premises and residents and persons working in the area.

8.4 Any conditions attached to licences will be tailored to the individual needs, style and characteristics of the particular premises and events concerned and will be drawn from a 'model pool of conditions' (where appropriate) to the particular premises.

7. Determination of the Application

Members can take the following steps when determining a new premises licence application:

- grant the licence;
- exclude from the scope of the licence any of the licensable activities to which the application relates;
- refuse to specify a person in the licence as the premises supervisor;
- reject the application

8. Associated Papers

- A. Application Form & plan
- B. Police Representations
- C. Public Safety Representation
- D. Licensing Rep & Withdrawal
- E. NCT Rep & withdrawal
- F. OS Map



Brent

NEW PREMISES LICENCE APPLICATION FORM

Application for a premises licence to be granted
under the Licensing Act 2003

PLEASE READ THE FOLLOWING INSTRUCTIONS FIRST

Before completing this form please read the guidance notes at the end of the form.
If you are completing this form by hand please write legibly in **block capitals**. In all cases ensure that your answers are inside the boxes and written in **black ink**. Use additional sheets if necessary.
You may wish to keep a copy of the completed form for your records.

I/We.....SATYANARAYAN RESTAURANT LTD.....

.....apply for a premises licence under
section 17 of the Licensing Act 2003 for the premises described in Part 1 below (the
premises) and I/we are making this application to you as the relevant licensing authority in
accordance with section 12 of the Licensing Act 2003

Part 1 – Premises Details

Postal address of premises or, if none, ordnance survey map reference or description 23, 24, 25 QUEENSBURY STATION PARADE	
Post town EDGWARE	Post code HA8 5NR

Telephone number of premises (if any)

Non-domestic rateable value of premises

Part 2 - Applicant details

Please state whether you are applying for a premises licence as

Please tick ✓ Yes

- a) An individual or individuals* ☐ please complete section (A)
- b) a person other than an individual* ☒ please complete section (B)
- i. as a limited company/limited liability partnership ☐ please complete section (B)
- ii. as a partnership (other than limited liability) ☐ please complete section (B)
- iii. as an unincorporated association or ☐ please complete section (B)
- iv. other (for example a statutory corporation) ☐ please complete section (B)
- c) a recognised club ☐ please complete section (B)
- d) a charity ☐ please complete section (B)
- e) the proprietor of an educational establishment ☐ please complete section (B)
- f) a health service body ☐ please complete section (B)
- g) a person who is registered under Part 2 of the Care Standards Act 2000 (c14) in respect of an independent hospital in Wales ☐ please complete section (B)
- ga) A person who is registered under Chapter 2 of Part 1 of the Health and Social Care Act 2008 (within the meaning of that Part) in an independent hospital in England ☐ please complete section (B)
- h) the chief officer of police of a police force in England and Wales ☐ please complete section (B)

* If you are applying as a person described in (a) or (b) please confirm:

Please tick ✓ Yes

- I am carrying on or proposing to carry on a business which involves the use of the premises for licensable activities; or ☒
- I am making the application pursuant to a
- o Statutory function or ☐
 - o A function discharged by virtue of Her Majesty's prerogative ☐

(A) INDIVIDUAL APPLICANTS (fill in as applicable)

Mr ☐ Mrs ☐ Miss ☐ Ms ☐ Other title ☐ (for example, Rev)

Surname

First names

Date of Birth

I am 18 years old or over ☐ (Please tick yes)

Nationality

Current postal address if different from premises address

Post Town

Postcode

Daytime contact telephone number

E-mail address (optional)

SECOND INDIVIDUAL APPLICANT (if applicable)Mr ☐Mrs ☐Miss ☐Ms ☐Other title
(for example, Rev) ☐

Surname

First names

Date of Birth

I am 18 years old or over ☐ (Please tick yes)

Nationality

Current postal
address
if different from
premises address

Post Town

Postcode

Daytime contact telephone number

E-mail address
(optional)**(B) OTHER APPLICANTS**

Please provide name and registered address of applicant in full. Where appropriate please give any registered number. In case of a partnership or other joint venture (other than a body corporate), please give the name and address of each party concerned.

Name	SATYANARAYAN RESTAURANT Ltd
Address	[REDACTED] [REDACTED] [REDACTED]
Registered number (where applicable)	[REDACTED]
Description of applicant (for example, partnership, company, unincorporated association etc.)	[REDACTED]
Telephone number (if any)	[REDACTED]
E-mail address (optional)	[REDACTED]

Part 3 Operating Schedule

When do you want the premises licence to start?

Day		Month		Year			
0	1	1	0	2	0	1	8

If you wish the licence to be valid only for a limited period, when do you want it to end?

N	A						
---	---	--	--	--	--	--	--

If 5,000 or more people are expected to attend the premises at any one time, please state the number expected to attend

N/A

Please give a general description of the premises (please read guidance note 1)

THE PREMISES IS LOCATED OVER 3 SHOPS ^{UNITS} OF A TOTAL OF 3000 SQ FEET. THE AREA WILL BE SPLIT IN HALF. ONE HALF WILL SERVE AS A VEGETARIAN RESTAURANT OF 100 SEATER WITH A SMALL BAR, OFFERING TAPAS STYLE FOOD FROM A REGION OF GUJARAT CALLED KATHYAVAD#. THE OTHER HALF WILL BE A BANQUETING HALL AVAILABLE FOR HIRE AND WILL ALSO HAVE A SMALL BAR IF GUESTS REQUIRE. (CAPACITY 100 PEOPLE) THE RESTAURANT WILL PLAY SOFT RECORDED MUSIC WHILE DINING. THE BANQUETING WILL BE PER GUESTS REQUIREMENTS - EITHER RECORDED OR LIVE SO REQUIRE A LICENCE FOR BOTH. IF WE CAN GET A LATER LICENCE FOR THURSDAY, FRIDAY AND SATURDAY THAT WOULD BE GREAT AND GUESTS CAN HAVE THAT OPTION. I HAVE ALSO ASKED FOR A LATER LICENCE IF POSSIBLE FOR CHRISTMAS & NEW YEARS EVE.

What licensable activities do you intend to carry on from the premises?

(Please see sections 1 and 14 of the Licensing Act 2003 and Schedule 1 and 2 to the Licensing Act 2003)

Provision of regulated entertainment

- a) plays (if ticking yes, fill in box A) ☐
- b) films (if ticking yes, fill in box B) ☐
- c) indoor sporting events (if ticking yes, fill in box C) ☐
- d) boxing or wrestling entertainment (if ticking yes, fill in box D) ☐
- e) live music (if ticking yes, fill in box E) ☒
- f) recorded music (if ticking yes, fill in box F) ☒
- g) performances of dance (if ticking yes, fill in box G) ☐
- h) anything of a similar description to that falling within (e), (f) or (g) (if ticking yes, fill in box H) ☐

Provision of late night refreshment (if ticking yes, fill in box I) ☐**Sale of alcohol** (if ticking yes, fill in box J) ☒

In all cases complete boxes K, L and M

A

Plays Standard days and timings (please read guidance note 7)			Will the performance of a play take place indoors or outdoors or both – please tick [✓] (please read guidance note 3).	Indoors	
Day	Start	Finish		Outdoors	
Mon			Please give further details here (please read guidance note 4)	Both	
Tue			State any seasonal variations for performing plays (please read guidance note 5)		
Wed			Non standard timings. Where you intend to use the premises for the performance of plays at different times to those listed in the column on the left, please list (please read guidance note 6)		
Thur					
Fri					
Sat					
Sun					

D

Boxing or wrestling entertainment Standard days and timings (please read guidance note 7)			Will the boxing or wrestling entertainment take place indoors or outdoors or both – please tick [✓] (please read guidance note 3).	Indoors	
				Outdoors	
				Both	
Day	Start	Finish	<u>Please give further details here</u> (please read guidance note 4)		
Mon					
Tue					
Wed			<u>State any seasonal variations for boxing or wrestling entertainment</u> (please read guidance note 5)		
Thur					
Fri					
Sat			<u>Non standard timings. Where you intend to use the premises for boxing or wrestling entertainment at different times to those listed in the column on the left, please list</u> (please read guidance note 6)		
Sun					

E

Live Music Standard days and timings (please read guidance note 7)			Will the performance of live music take place indoors or outdoors or both – please tick [✓] (please read guidance note 3)	Indoors	✓
				Outdoors	
				Both	
Day	Start	Finish	<u>Please give further details here</u> (please read guidance note 4) ONLY WHEN BANQUETING HALL IS BEING RENTED AND IF CUSTOMER CHOOSES THIS OPTION.		
Mon	12.00	23.00			
Tue	12.00	23.00			
Wed	12.00	23.00	<u>State any seasonal variations for the performance of live music</u> (please read guidance note 5) CHRISTMAS EVE & NEW YEARS EVE UNTIL 04.00		
Thur	12.00	01.00			
Fri	12.00	01.00			
Sat	12.00	01.00	<u>Non standard timings. Where you intend to use the premises for the performance of live music at different times to those listed in the column on the left, please list</u> (please read guidance note 6)		
Sun	12.00	00.00			

F

Recorded music Standard days and timings (please read guidance note 7)			Will the playing of recorded music take place indoors or outdoors or both – please tick [✓] (please read guidance note 3)	Indoors	<input checked="" type="checkbox"/>
				Outdoors	
				Both	
Day	Start	Finish			
Mon	12.00	23.00	<u>Please give further details here</u> (please read guidance note 4) BACKGROUND MUSIC PLAYING IN RESTAURANT.		
Tue	12.00	23.00			
Wed	12.00	23.00	<u>State any seasonal variations for playing recorded music</u> (please read guidance note 5) CHRISTMAS & NEW YEARS EVE UNTIL 04.00		
Thur	12.00	01.00			
Fri	12.00	01.00	<u>Non standard timings. Where you intend to use the premises for the playing of recorded music at different times to those listed in the column on the left, please list</u> (please read guidance note 6) UNLESS BANQUETING REQUEST FOR PRIVATE HIRE		
Sat	12.00	01.00			
Sun	12.00	00.00			

G

Performances of dance Standard days and timings (please read guidance note 7)			Will the performance of dance take place indoors or outdoors or both – please tick [✓] (please read guidance note 3).	Indoors	
				Outdoors	
				Both	
Day	Start	Finish			
Mon			<u>Please give further details here</u> (please read guidance note 4)		
Tue					
Wed			<u>State any seasonal variations for the performance of dance</u> (please read guidance note 5)		
Thur					
Fri			<u>Non standard timings. Where you intend to use the premises for the performance of dance at different times to those listed in the column on the left, please list</u> (please read guidance note 6)		
Sat					
Sun					

Late night refreshment Standard days and timings (please read guidance note 7)			Will the provision of late night refreshment take place indoors or outdoors or both – please tick [✓] (please read guidance note 3).	Indoors	
				Outdoors	
				Both	
Day	Start	Finish	Please give further details here (please read guidance note 4)		
Mon					
Tue					
Wed			State any seasonal variations for the provision of late night refreshment (please read guidance note 5)		
Thur					
Fri					
Sat			Non standard timings. Where you intend to use the premises for the provision of late night refreshment at different times, to those listed in the column on the left, please list (please read guidance note 6)		
Sun					

Supply of alcohol Standard days and timings (please read guidance note 7)			Will the supply of alcohol be for consumption (Please tick box ✓) (please read guidance note 8)	On the premises	✓
				Off the premises	
				Both	
Day	Start	Finish	State any seasonal variations for the provision of late night refreshment (please read guidance note 5)		
Mon	12.00	23.00			
Tue	12.00	23.00			
Wed	12.00	23.00	CHRISTMAS EVE AND NEW YEARS EVE UNTIL 04.00		
Thur	12.00	01.00			
Fri	12.00	01.00			
Sat	12.00	01.00			
Sun	12.00	00.00			
			Non-standard timings. Where you intend to use the premises for the supply of alcohol at different times to those listed in the column on the left, please list (please read guidance note 6)		

State the name and details of the individual whom you wish to specify on the licence as designated premises supervisor (Please see declaration about the entitlement to work in the checklist at the end of the form):

Name KUNNAL NARANG
 Date of Birth [REDACTED]
 Address [REDACTED]
 Postcode [REDACTED]
 Personal Licence number(if known) —
 Issuing licensing authority (if known) —

K

Please highlight any adult entertainment or services, activities, other entertainment or matters ancillary to the use of the premises that may give rise to concern in respect of children (please read guidance note 9)

N/A

L

Hours premises are open to the public

Standard days and timings
(please read guidance note 7)

State any seasonal variation (please read guidance note 5)

CHRISTMAS EVE & NEW YEARS EVE UNTIL 04.00

Non-standard timings. Where you intend to use the premises to be open to the public at different times to those listed in the column on the left, please list (please read guidance note 6)

Day	Start	Finish
Mon	12.00	23.00
Tue	12.00	23.00
Wed	12.00	23.00
Thur	12.00	01.00
Fri	12.00	01.00
Sat	12.00	01.00
Sun	12.00	00.00

M

Describe the steps you intend to take to promote the four licensing objectives:

a) General – all four licensing objectives (b, c, d, e) (please read guidance note 10)

- TRAINING OF STAFF
- STRONG MANAGEMENT CONTROLS
- NO SELLING OF ALCOHOL TO UNDERAGE
- NO DRUNK & DISORDERLY BEHAVIOUR ON THE PREMISES AREA
- VIGILANCE IN PREVENTING USE & SALE OF ILLEGAL DRUGS
- NO VIOLENCE & HARM TO CHILDREN

b) The prevention of crime and disorder

- CCTV ON PREMISES
- NOTICE INDICATING NORMAL OPENING HOURS
- CLEAR NOTICE WARNING OF CRIMINAL ACTIVITY
- NOT SELLING ALCOHOL TO DRUNK OR INTOXICATED CUSTOMERS
- PREVENTION IN ILLEGAL DRUG USE IN RETAIL AREA
- STAFF WILL BE TRAINED TO ASK CUSTOMERS TO USE PREMISES IN AN ORDERLY & RESPECTFUL MANNER

c) Public safety

- INTERNAL & EXTERNAL LIGHTING TO PROMOTE SAFETY
- STAFF TRAINING TO ENVIRONMENTAL HEALTH REQUIREMENT
- TRAINING & IMPLEMENTATION OF UNDERAGE ID CHECKS
- ALL FIXTURES AND FITTINGS CHECKED FOR SAFETY

d) The prevention of public nuisance

- NOISE REDUCTION MEASURES TO ADDRESS PUBLIC NUISANCE OBJECTIVES
- CLEAR NOTICES DISPLAYED AT EXIT REQUESTING PUBLIC TO RESPECT RESIDENTS & TO LEAVE QUIETLY.
- CUSTOMERS WILL BE ASKED NOT TO STAND AROUND TALKING LOUDLY OUTSIDE
- CUSTOMERS ONLY ALLOWED DURING OPENING HOURS
- WASTE RECEPTABLES AVAILABLE FOR CUSTOMER USE

e) The protection of children from harm

- "CHALLENGE 25" SIGN DISPLAYED ENCOURAGING ANYONE WHO IS OVER 18 BUT LOOKS UNDER 25 TO CARRY ACCEPTABLE ID IF THEY WISH TO BUY ALCOHOL.
- ALL DETAILS PROVIDED IN TRAINING RECORD BOOK AVAILABLE IN RETAIL UNIT
- LOG BOOK WILL BE KEPT ON PREMISES

Checklist

Please tick ✓ Yes

- I have made or enclosed payment of the fee ☒
- I have enclosed the plan of the premises ☒
- I have sent copies of this application and the plan to responsible authorities and others where applicable ☒
- I have enclosed the consent form completed by the individual I wish to be premises supervisor, if applicable ☐
- I understand that I must now advertise my application ☒
- I understand that if I do not comply with the above requirements my application will be rejected ☒
- (Applicable to all individual applicants, including those in a partnership which is not a limited liability partnership, but not companies or limited liability partnerships) I have included documents demonstrating my entitlement to work in the United Kingdom (please read note 15). ☒

IT IS AN OFFENCE, UNDER SECTION 158 OF THE LICENSING ACT 2003, TO MAKE A FALSE STATEMENT IN OR IN CONNECTION WITH THIS APPLICATION. THOSE WHO MAKE A FALSE STATEMENT MAY BE LIABLE ON SUMMARY CONVICTION TO A FINE OF ANY AMOUNT.

IT IS AN OFFENCE UNDER SECTION 24B OF THE IMMIGRATION ACT 1971 FOR A PERSON TO WORK WHEN THEY KNOW, OR HAVE REASONABLE CAUSE TO BELIEVE, THAT THEY ARE DISQUALIFIED FROM DOING SO BY REASON OF THEIR IMMIGRATION STATUS. THOSE WHO EMPLOY AN ADULT WITHOUT LEAVE OR WHO IS SUBJECT TO CONDITIONS AS TO EMPLOYMENT WILL BE LIABLE TO A CIVIL PENALTY UNDER SECTION 15 OF THE IMMIGRATION, ASYLUM AND NATIONALITY ACT 2006 AND PURSUANT TO SECTION 21 OF THE SAME ACT, WILL BE COMMITTING AN OFFENCE WHERE THEY DO SO IN THE KNOWLEDGE, OR WITH REASONABLE CAUSE TO BELIEVE, THAT THE EMPLOYEE IS DISQUALIFIED.

Part 4 – Signatures (please read guidance note 11)

Signature of applicant or applicant's solicitor or other duly authorised agent. (Please read guidance note 12). If signing on behalf of the applicant please state in what capacity.

Declaration

- (Applicable to individual applicants only, including those in a partnership which is not a limited liability partnership) I understand I am not entitled to be issued with a licence if I do not have the entitlement to live and work in the UK (or if I am subject to a condition preventing me from doing work relating to the carrying on of a licensable activity) and that my licence will become invalid if I cease to be entitled to live and work in the UK (please read guidance note 15).
- The DPS named in this application form is entitled to work in the UK (and is not subject to conditions preventing him or her from doing work relating to a licensable activity) and I have seen a copy of his or her proof of entitlement to work, if appropriate (please see note 15)

Signature *[Signature]*

Date 9/9/18

Capacity COMPANY DIRECTOR

For joint applications signature of 2nd applicant or 2nd applicant's solicitor or other authorised agent. (Please read guidance note 13). If signing on behalf of the applicant please state in what capacity.

Signature

Date 10/8/19

Capacity

Contact name (where not previously given) and postal address for correspondence associated with this application (please read guidance note 14)

SHITAL PATEL

[REDACTED]

[REDACTED]

Post town [REDACTED]

Post code [REDACTED]

Telephone number [REDACTED]

E-mail address (optional) [REDACTED]

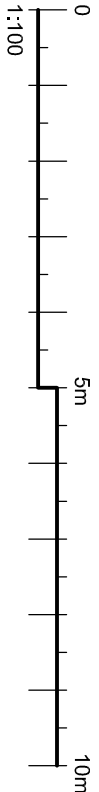
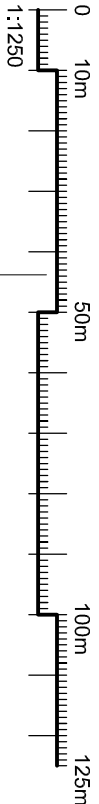

The Contractor is to check all dimensions on site and report any discrepancies to the Contract Administrator. This drawing is to be read in conjunction with all other standard documentation. Dimensions are not to be scaled from this drawing.

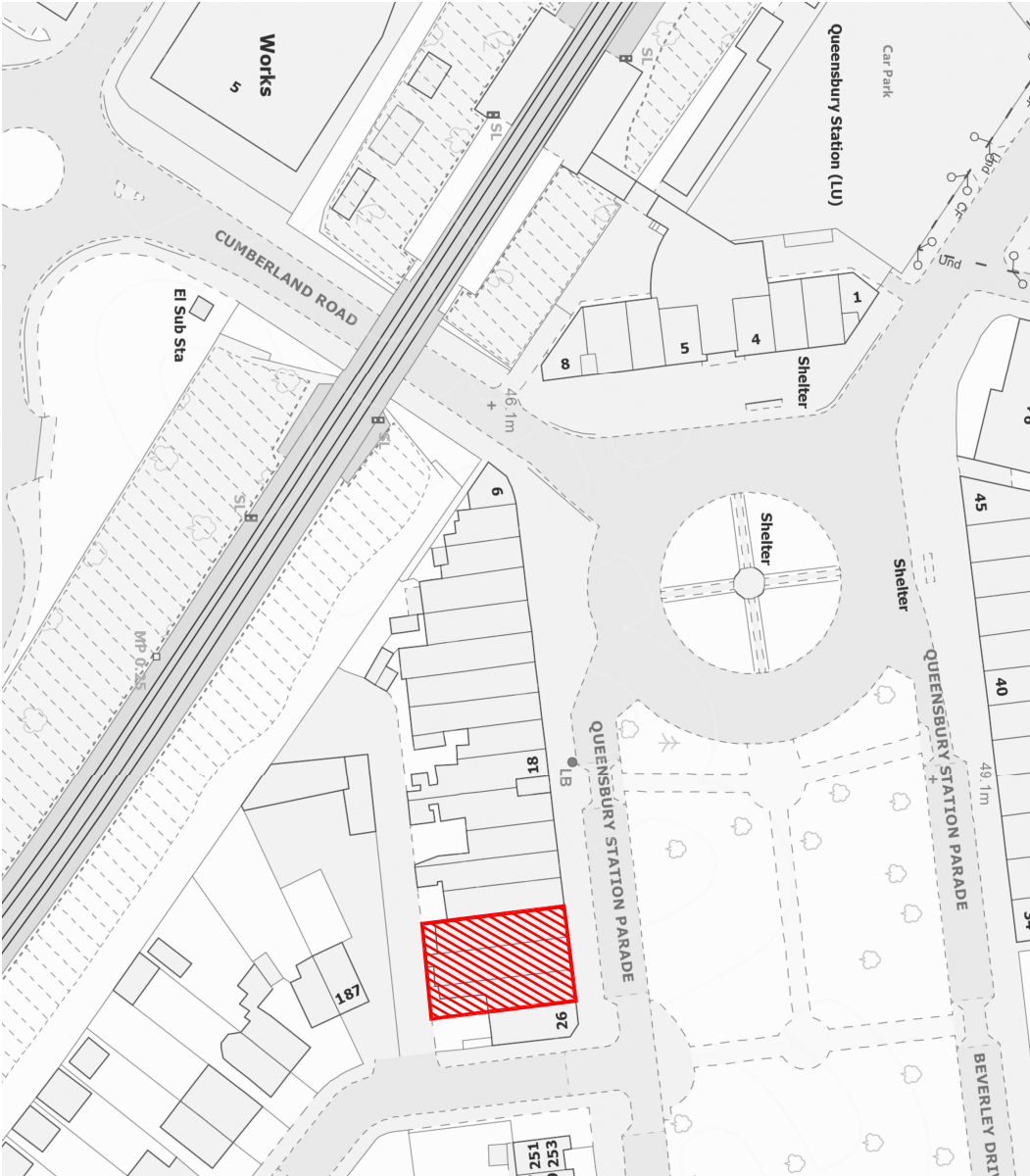

LOCATION PLAN - SCALE 1:11250

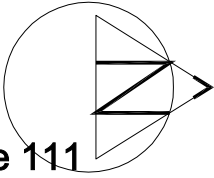

rev.	description	date	chkd.
	14 Leechcroft Avenue Slidcup Kent DA15 8RS 020 3004 9238 07931 931 035 s.nappal@dapconsultants.co.uk www.dapconsultants.co.uk		

project : 23-25 Queensbury Station Parade
Harrow

drawing title :

Existing Floor Plan

drawn: SN	chkd : SS	date:08.08.2018
status: Information		
scale:1:100@A3		
proj no : 972	drg no: 01	rev no: A



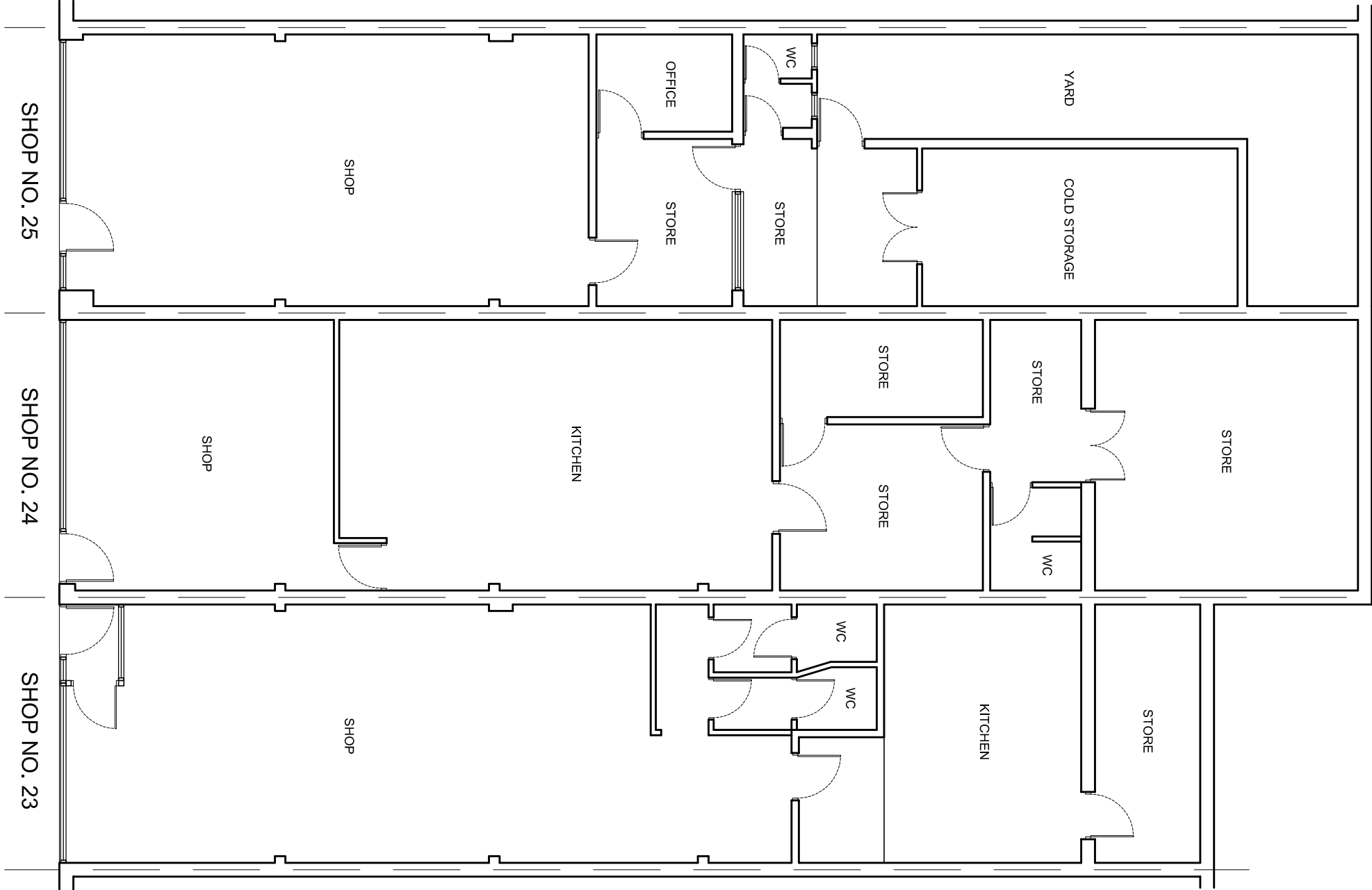



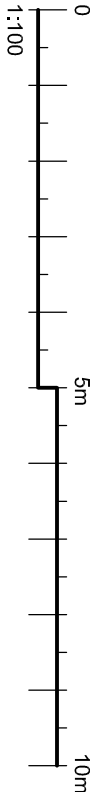



EXISTING FLOOR LAYOUTS





This page is intentionally left blank

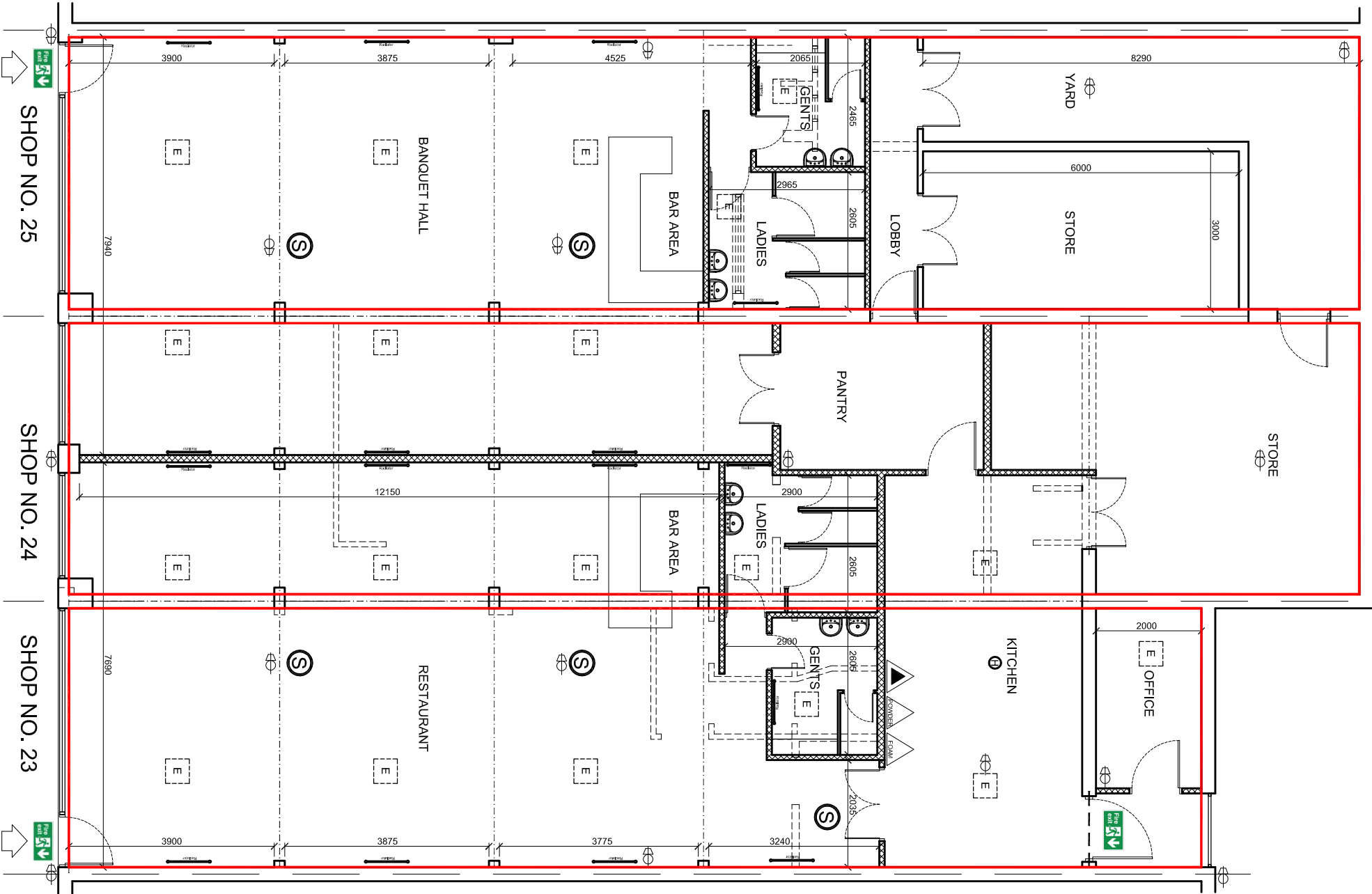

The Contractor is to check all dimensions on site and report any discrepancies to the Contract Administrator. This drawing is to be read in conjunction with all other standard documentation. Dimensions are not to be scaled from this drawing.

KEY:	
	Fire extinguisher 6 litre AFFF Foam Spray
	9 Litre water stored pressure
	6 kg (abc) powder
	Licensable Activities
	Heat Detector
	Smoke Detector
	Emergency lighting
	CCTV
	Fire Exit Signage
	Entrance to Restaurant and Banquet Hall



rev.	description	date	chkd.
 14 Leechcroft Avenue Sidcup Kent DA15 8RS 020 3004 9238 07931 931 035 s.nagpal@dapconsultants.co.uk www.dapconsultants.co.uk			

project : 23-25 Queensbury Station Parade
Harrow

drawing title :
Proposed Floor Plan

drawn: SN	chkd : SS	date:08.08.2018
status: Information		
scale:1:100@A3		
proj no : 972	drg no: 02	rev no: A

This page is intentionally left blank



**METROPOLITAN
POLICE**

Working together for a safer London

TERRITORIAL POLICING

Brent Police Licensing Unit

*Brent Civic Centre
Engineers Way
Wembley
Middlesex
HA9 0FJ*

Brent Borough Licensing Department

*Wembley Police Station
603 Harrow Road
Wembley
HA0 2HH*

Tel: 020 8733 3206

Email: Gary.L.R.Norton@met.police.uk

Web: www.met.police.uk

Your ref: L.A.Ref 13499

Date: 12th October 2018

Our ref: 01QK/13499/18/965

Police representation to the Premises Licence application for 'SATYANARAYAN RESTAURANT LTD, 23-25 QUEENSBURY STATION PARADE, LONDON, HA8 5NR'

I certify that I have considered the application shown above and **I wish to make representations** that the likely effect of the grant of the application is detrimental to the Council's Licensing Objectives for the reasons indicated below.

I am of the opinion that the risk to the Council's objectives can be mitigated by attaching conditions to the Licence as shown below.

If these conditions were accepted in full, **I would** withdraw my representation.

Officer: **Gary Norton**
Licensing Constable PC965QK

An officer of the Metropolitan Police, in whose area the premises are situated, who is authorised for the purposes of exercising its statutory function as a 'Responsible Authority' under the Licensing Act 2003. The application has been made for a premises licence under section 17 of the act.

The Police representations are primarily concerned with crime and disorder, public safety and public nuisance.

I had a telephone conversation with the applicant who informed me she had not got the keys to the premises as yet, so no work had commenced. Nor could I have entry to look inside the premises. Therefore, I have had to assess the application based on the paperwork submitted and a site visit to survey the exterior of location and its surroundings. The architect plans suggest building work will be carried out to merge three premises into one restaurant/banqueting hall. There will be a dividing partition wall to separate the two elements. The surrounding area is a densely populated residential area with flats that sit directly on top of the premises front and rear, akin to a shopping parade with a rear access alley. Therefore, I have concerns over the request to have the premises open as late as 0100hrs due to public nuisance, crime and disorder issues.

A major concern regarding the premises is what is its actual function and purpose based on the information provided in the application. By definition, a restaurant or banquet suggests substantial food is being served. However, the premises is only serving food until 2300hrs,

but is requesting live & recorded music and sale of alcohol as late as 0100hrs. This suggests it is operating more as a late night bar or club than as a restaurant at the weekends. Given that the premises has yet to be built and the "noise reduction measures to address public nuisance objectives" are unspecified, I also have concerns over the noise and vibration coming from the premises, which could disturb residents. The other issue is the coming and going of customers and when also as it closes. If the premises is at capacity, the egress of a 200 inebriated patrons, revving car engines and cabs coming and going will also cause a nuisance. The area itself has ongoing crime and disorder issues of its own, recent multiple shootings (May 2018) believed associated to local drug dealers.

ASB, Violent crime, Robbery and drug offences account for well over 50% of all crime recorded in Queensbury (Sept 2017-Aug 2018: ukcrimestats.com). Having a bar/club operating into the early hours of the weekend will be looked at as another opportunity by drug dealers to ply their trade.

The supply of alcohol and the request for music runs right up until the closing times applied for. I believe it is a good idea to allow a drinking-up period, to prevent late closing or prolonged drinking beyond closing times resulting in licence breaches. Therefore, I recommend the sale of alcohol times should be half an hour before the revised, respective closing times.

Based on these findings, Police would require the following points be included in the operating schedule, or added as conditions on the premises licence.

Personal Licence Holder

The sale of alcohol to drunken people and children is a major cause of concern to police and highlighted in the Governments Alcohol Harm Reduction Strategy. Those who sell alcohol should be fully aware of the legislation and issues around alcohol and should be fully trained to a national standard.

Closed Circuit Television (CCTV)

Good quality CCTV is essential as a deterrent for the prevention of crime and the detection of offenders. It allows for both covert and overt monitoring of the premises. With proper signage, this reassures both staff and clientele, that this is a safe environment where illegal activities are not tolerated.

All cameras and recording equipment will be installed and maintained in accordance with Home Office Guidance and the manufacturers instructions and will be fully operational when the premises are open to the public.

Notices shall be displayed at the entrance to the premises, and in prominent positions throughout the premises, advising that CCTV is in operation.

Operating Hours to be displayed on Premises

A notice displaying the opening hours, the type of licensing activity and licence conditions should be clearly displayed and visible to anyone outside the premises. This may be incorporated in the summary of the licence, which must be displayed, or take the form of a separate item. Likewise the name of the Designated Premises Supervisor (D.P.S.) should be similarly displayed. This will allow the Police and other responsible authorities to readily identify the licence details. Clearly displayed opening hours will also reduce any confusion for customers prior to entering the premises and possible conflict when the premises close/stop selling alcohol.

A Summary of the Premises Licence will be displayed at each public entrance to the premises.

Police require the following points should be added as conditions on the premises licence as below.

CCTV shall be installed to Home Office Guidance standards and maintained in a good working condition and recordings shall be kept for 31 days and shall be made available to police and authorised Officers from Brent Council upon request.

The CCTV system shall be capable of obtaining clear facial recognition images and a clear head and shoulders image of every person entering or leaving the premises.

A copy of the premises licence summary including the hours which licensable activities are permitted shall be visible from the outside of each entrance to the premises.

A "Challenge 25" policy shall be adopted and adhered to.

A sign stating "No proof of age – No sale" shall be displayed at the point of sale.

Any staff directly involved in selling alcohol for retail to consumers, staff who provide training and all managers will undergo regular training of Licensing Act 2003 legislation. This will be documented and signed for by the DPS and the member of staff receiving the training. This training log shall be kept on the premises and made available for inspection by police and relevant authorities upon request.

An incident log shall be kept at the premises, and made available for Inspection on request to an authorised officer of Brent Council or the Police, which will record the following:

All crime reported to the venue

Any complaints received

Any faults in the CCTV system

Any refusal of the sale of alcohol

Any visit by a relevant authority or emergency service.

Alcohol to be consumed on the premises shall only be provided as an accompaniment to a meal, Customers are not be allowed to sit, stand or be served from the bar area, or any other staff area used for the preparation of alcoholic beverages.

Signs must be displayed at suitable points along the bar reading 'Service is by waiter/waitress service only.

Customers shall not be permitted to take open drink containers outside the premises as defined on the plan submitted to and approved by the Licensing Authority.

Notices asking customers to leave quietly shall be conspicuously displayed at all exits.

No noise or vibration shall be detectable at any neighbouring noise sensitive premises.

The playing of live or recorded music shall not be permitted in any garden or external area.

All doors and windows shall remain closed during any licensable activity and where a door is used for patrons to enter or leave the premises the door shall be lobbied and fitted with a self-closing device

All regulated entertainment shall conclude (number) minutes before the premises are due to close each day.

A designated smoking area should be located at the front of the premises and limited to 10 persons at any one time.

The total number of people on the premises including staff and performers shall not exceed a number as set out by Brent Council's health & Safety team.

All licensable activities shall conclude 30 minutes before the premises are due to close each day.

I would also propose opening/closing times as follows:

Sunday to Wednesday 1200hrs to 2300hrs.

Thursday to Saturday 1200hrs to 0000hrs.

The supply of alcohol hours should be revised as follows:

Sunday to Wednesday 1200hrs to 2230hrs.

Thursday to Saturday 1200hrs to 2330hrs.

Yours Sincerely,

Gary Norton 965QK
Licensing Constable Brent Police

From: Shital Patel
Sent: 16 October 2018 12:56
To: Gary.L.R.Norton@met.police.uk
Cc: Business Licence <business.licence@brent.gov.uk>; Patel, Yogini Linda.Legister
Subject: Re: Emailing: SATYANAYARAN RESTAURANT REPS

Dear Pc Norton,

Many thanks for your email.

I have spoken to my estate agent and he has agreed to give me access to the property if need be on these circumstances as we still have not moved to Solicitor's hands and don't know when that will be. So please let me know if you would like to meet at the premises and I can get it organised with the agent.

So at the premises food will be served until 11pm but we only require a later license if a customer decides to hire the banqueting area and wants to stay until later for a specific function. It is only available as an option if the customer requires and I assure you it won't turn into a late night bar/club as that is not what we are trying to promote. In most instances the customer will leave at an earlier time and most guests leave soon after the food is served meaning not all the guests leave at the same time, hence reducing noise pollution. The banqueting will only be for a maximum of 100 people. The restaurant will be operated separately so those guests will leave when they finish so when they leave it will be staggered.

I understand crime rate is high in this area but the type of crowd we will be attracting will be a family crowd who won't be interested in buying such drugs so will not increase to the crime rate in the area.

Please consider these points and confirm back to me on timings to give the maximum possible time you can. I agree to all the other points noted by yourself.

Many thanks
Shital Patel

This page is intentionally left blank

From: Pearce, Chris
Sent: 22 October 2018 11:02
To: ENS Public Safety <ens.publicsafety@brent.gov.uk>; 'Shital' shailender nagpal Legister, Linda <Linda.Legister@brent.gov.uk>
Cc: Mayank patel Gets
Subject: RE: CONSULT - New Premises - Satyanarayan, 23-25 Queensbury Station Parade - 13499

Dear Sirs

RE: Licensing Act 2003
Application for the Grant of a New Premises Licence
New Premises - Satyanarayan, 23-25 Queensbury Station Parade – 13499

I refer to the application for a new licence for the above named premises. After assessing the application, the Public Safety Team will be making the following representations to the Licensing Authority on the grounds of Public Safety.

Providing the licensee is willing to accept the following conditions Public Safety Team would withdraw the representation.

- The locks and flush latches on the exit doors and gates shall be unlocked and kept free from fastenings other than push bars or pads whilst the public are on the premises.
- The socket outlets (or other power supplies used for DJ equipment, band equipment and other portable equipment) that are accessible to performers, staff or the public shall be suitably protected by a residual current device (RCD having a rated residual operating current not exceeding 30 milliamps).
- Exits are not obstructed (including by curtains, hangings or temporary decorations), and accessible via non-slippery and even surfaces, free of trip hazards and clearly identified
- Where chairs and tables are provided, internal gangways are kept unobstructed
- Temporary electrical wiring and distribution systems are not provided without notification to the licensing authority at least ten days before commencement of the work and/or prior inspection by a suitable qualified electrician.
- Subject to risk assessment, the maximum number of persons permitted on the Premises (not including staff) shall be: 150 persons

In order for the Public Safety Team to withdraw this representation, it will be necessary for you or your client to **confirm in writing or via Email** that you accept the above licence conditions.

We will require these conditions to appear on the licence schedule should the licence be granted.

If you are in control of any part of a commercial premise, you are under a legal obligation to carry out a detailed fire risk assessment to identify risks and hazards in the premises. A fire risk assessment is essential in keeping your premises safe for everyone. You must keep a written record of your fire risk assessment if your business has five or more people.

More information can be found here: <http://www.london-fire.gov.uk/FireRiskAssessment.asp>

Please let me know if I can assist you further.

Kind regards

Mr Chris Pearce
Public Safety Officer
Regeneration & Environmental Services
Brent Council
020 8937 1031

Satyanarayan Restaurant Ltd
23-25 Queensbury Station Parade
Edgware
HA8 5NR

12 October 2018

Licensing Representation to the Application for a new Premises Licence for Satyanarayan Restaurant Ltd, 23-25 Queensbury Station Parade, Edgware, HA8 5NR

I certify that I have considered the application shown above and I wish to make a representation.

An officer of the Licensing Authority, in whose area the premises are situated, who is authorised for the purposes of exercising its statutory function as a 'Responsible Authority' under the Licensing Act 2003.

The application has been made for a new premises licence under section 17 of the Act.

The Licensing Authority representations are primarily concerned with the four licensing objectives;

- the prevention of crime and disorder;
- public safety;
- the prevention of public nuisance; and
- the protection of children from harm.

The Licensing Authority require the following points to be included in the operating schedule or added as conditions on the premises licence:

1. CCTV shall be installed to Home Office Guidance standards and maintained in a good working condition and recordings shall be kept for 31 days and shall be made available to police and authorised Officers from Brent Council.
2. A CCTV camera shall be installed to cover the entrance of the premises and further cameras to cover the bar areas and tills.
3. A member of staff trained in the use of the CCTV system shall be available at the premise at all times that the premises are open to the public.
4. A copy of the premises licence summary including the hours which licensable activities are permitted shall be visible from the outside of each entrance to the premises.

5. Notices asking customers to leave quietly shall be conspicuously displayed at all exits.
6. Customers shall not be permitted to take open glass containers outside the premises as defined on the plan submitted to and approved by the Licensing Authority.
7. The licensee shall ensure customers leave the premises in a quiet and orderly manner.
8. No children shall be admitted unless accompanied by a responsible adult. All children must leave the premises by midnight.
9. A sign stating 'No proof of age, No sale' shall be displayed at the point of sale.
10. Any staff directly involved in selling alcohol for retail to consumers and staff who provide training including managers shall undergo regular training of the Licensing Act 2003 legislation (at least every 12 months). The training shall be documented and signed off by the DPS and the member of staff receiving the training. This training log shall be kept centrally and made available for inspection by police and relevant authorities upon request.
11. A 'Challenge 25' policy shall be adopted and adhered to
12. Alcohol shall only be provided as an accompaniment to a main meal in the restaurant area.
13. Door supervisors of a sufficient number and gender mix, shall be employed in the banqueting hall from 21:30 hours on any day when it is in use for the sale of alcohol past midnight.
14. A maximum of 5 persons shall be permitted to smoke outside the premises at any one time.
15. The rear external area shall not be for customer use.
16. There shall be no live or recorded music played in the restaurant area.
17. Substantial snacks and non-intoxicating beverages shall be available during the whole of licensed hours in all parts of the premises where intoxicants are provided.
18. No noise or vibration shall be detectable at any neighbouring noise sensitive premises. The level of music shall be arranged so as not to cause a nuisance to local residents.
19. An incident log shall be kept at the premises, and made available for inspection on request to an authorised officer of Brent Council or the Police, which will record the following:
 - (a) all crimes reported to the venue
 - (b) all ejections of patrons
 - (c) any complaints received
 - (d) any incidents of disorder
 - (e) all seizures of drugs or offensive weapons
 - (f) any faults in the CCTV system
 - (g) any visit by a relevant authority or emergency service.

Change in Closing Hours

The Licensing Authority require that there be a period of 30 minutes between when licensable activities cease and customers leave the premises. In order to meet this requirement we ask that the closing times be modified from:-

Monday – Wednesday 23.00hrs

Thursday – Saturday 01.00hrs
Sunday 00.00

To

Monday – Wednesday 23.30hrs
Thursday – Saturday 01.30hrs
Sunday 00.30

In order for the Licensing Team to withdraw this representation, it will be necessary for you to confirm that you accept the above conditions and changes in timings in writing.

Yours sincerely



Susana Figueiredo
Licensing Inspector
Regulatory Services

This page is intentionally left blank

From: Figueiredo, Susana
Sent: 14 October 2018 17:19
To: 'Shital Patel'
Cc: Business Licence <business.licence@brent.gov.uk>
Subject: CONSULT - New Premises - Satyanarayan, 23-25 Queensbury Station Parade - 13499

Dear Shital Patel,

Thank you for your email.

As a result of your agreement of the attached conditions, I am now withdrawing my representation and have no further comments to make.

You do not need to take any further action in terms of the licensing authority's representation but may still need to respond to other responsible authorities.

Kind Regards

Susana Figueiredo
Licensing Enforcement Officer

From: Shital Patel
Sent: 14 October 2018 14:09
To: Figueiredo, Susana
Subject: Re: CONSULT - New Premises - Satyanarayan, 23-25 Queensbury Station Parade - 13499

Hi

I accept the conditions set out in your letter and confirm the changes of timings.

Please let me know if there is anything further I need to do?

Many thanks
Shital Patel

This page is intentionally left blank

From: Joshi, Ketan
Sent: 18 October 2018 11:07
To: 'Shital Patel'
Cc: Business Licence <business.licence@brent.gov.uk>
Subject: RE: New Premises Licence Application Reference: 13499 - Satyanarayan, 23-25 Queensbury Station Parade, Edgware, HA8 5NR

Dear Ms Patel

Thank you for your response. I confirm that I am now in a position to withdraw my representation.

Regards

Ketan Joshi
Environmental Health Officer

From: Shital Patel
Sent: 14 October 2018 14:05
To: Joshi, Ketan
Subject: Re: New Premises Licence Application Reference: 13499 - Satyanarayan, 23-25 Queensbury Station Parade, Edgware, HA8 5NR

Hi

Many thanks for your email.

I will ensure the following measures take place for noise reduction to address public nuisance.

- I will ensure the noise is not audible outside the premises and to other business premises in the area by soundproofing the premises.
- I will keep windows and doors closed as the premises will be fitted with air conditioning as to avoid opening windows.
- i will provide sound insulation to emergency exit doors and extractor fans.
- I will keep speakers within premises and will not position them near to openings such as doors and windows.
- I will not deliberately play, or direct music outside the premises as a means of attracting customers.
- I will play sound amplification systems through a sound limiting device.
- will use in- house speakers rather than artist Dj speaker system
- provide sound insulated enclosures to external plant and machinery
- provide sound insulation to ventilation ductwork and outlets
- use anti-vibration mountings for speakers
- use rubber matting and handling aids for the movement of barrels, cylinders, bottles etc.
- ensure all staff, Dj's and artists understand the noise control requirements by providing training
- operate at realistic times, which will not impact others
- play relaxing or calming music towards end of the event to allow customers to leave naturally and not in large groups
- use signs to advice to be quiet when leaving premises. Ban people who do not cooperate

- arrange for deliveries to be made at reasonable times
- carry out regular checks to ensure noise is being adequately controlled
- ask residents or businesses around the area for feedback.

I also confirm I am willing to abide to the below conditions set to below.

Please let me know if you need any other information.

Many thanks

Shital Patel

From: Joshi, Ketan
Sent: 11 October 2018 17:23
To: 'pshital
Cc: Business Licence <business.licence@brent.gov.uk>
Subject: New Premises Licence Application Reference: 13499 - Satyanarayan, 23-25 Queensbury Station Parade, Edgware, HA8 5NR

Dear Applicant,

I certify that I have considered this application for a New Premises Licence for premises: Satyanarayan, 23-25 Queensbury Station Parade, Edgware, HA8 5NR.

I acknowledge that the licensable activities proposed are:

- **Live music** (Mon-Wed 12:00-23:00hrs, Thur-Sat 12:00-01:00hrs, Sun 12:00-00:00)
- **Recorded music** (Mon-Wed 12:00-23:00hrs, Thur-Sat 12:00-01:00hrs, Sun 12:00-00:00)
- **The sale by retail of alcohol** (Mon-Wed 12:00-23:00hrs, Thur-Sat 12:00-01:00hrs, Sun 12:00-00:00)

I wish to make representations that the likely effect of the approval of this premises licence is detrimental to the Licensing Objectives with regards to the prevention of public nuisance with due consideration to the type of regulated entertainment applied for and operating hours proposed. Representations are made on the grounds that public nuisance is likely to be experienced by the occupiers of neighbouring and nearby residential units.

It is recommended that the following conditions are attached to the premises licence to ensure that the licensing objective relating to public nuisance is upheld:

- 1. All doors and windows shall remain closed during the licensed activities.**
- 2. Music played at the premises shall not be audible at or within the site boundary of any residential property. Designated site personnel shall monitor the boundary of the premises for any excessive sound breakout and take immediate action to remedy the situation.**

- 3. Prolonged congregations of patrons outside the premises shall be discouraged. Once patrons have finished smoking, they shall be asked to either return inside the premises or vacate the immediate area outside of the premises.**
- 4. Signs shall be displayed in prominent areas informing guests of the residential nature of the area and to conduct their behaviour accordingly.**
- 5. When the premises turn out, a staggered dispersal strategy shall be employed to ensure minimal noise disturbance to local residents.**
- 6. When the premises turn out, a door supervisor shall supervise guests and ensure they leave in a prompt and courteous manner, respecting the neighbours.**

With reference to section d (the prevention of public nuisance) of page 13, the application states *"noise reduction measures to address public nuisance objectives"* but it is not clear what these measures are. It is requested that you submit further details relating to the aforementioned "measures."

Please submit the requested information and also confirm if you are willing to agree to the above conditions. If you are willing to abide by the conditions, I will be in a position to withdraw my representation subject to above requested details relating to the "noise reduction measures" being satisfactory.

Regards

Ketan Joshi
Environmental Health Officer

This page is intentionally left blank

Satyanarayan OS Map

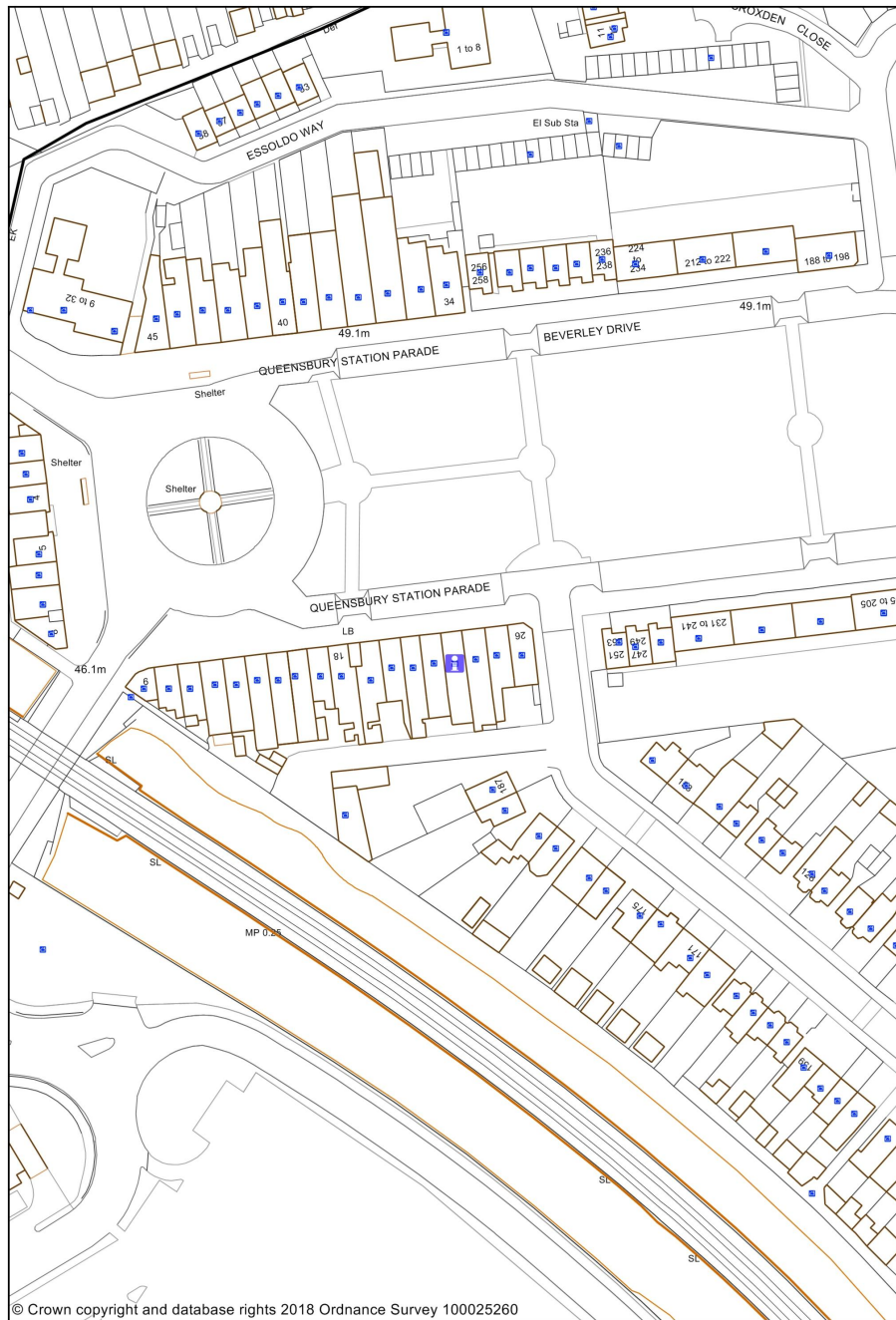

1:1250

0 0.02 0.04 kilometres



Brent

This page is intentionally left blank